

09/08/99

TIP PROJECT: W-5202B

See Sheet 1-A For Index of Sheets

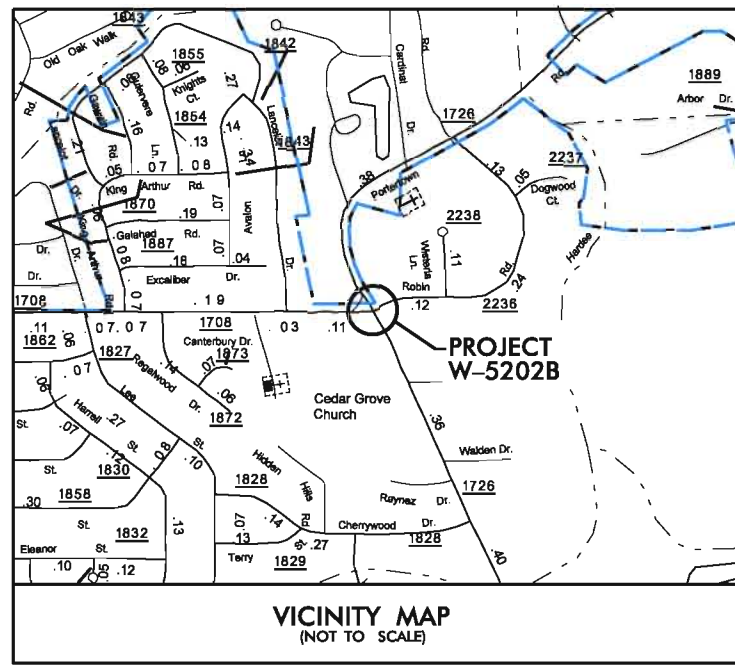

STATE OF NORTH CAROLINA
DIVISION OF HIGHWAYS

PITT COUNTY

**LOCATION: INTERSECTION OF SR 1708 (E. FIRE TOWER RD),
SR 1726 (PORTERTOWN RD), AND SR 2236
(ROBIN RD)**

**TYPE OF WORK: ROUNDABOUT, PAVING,
GRADING AND DRAINAGE**

STATE	STATE PROJECT REFERENCE NO.	SHEET NO.	TOTAL SHEETS
N.C.	W-5202B	1	
STATE PROJ. NO.	F.A. PROJ. NO.	DESCRIPTION	
45332.1.2		PE	
45332.2.2		RW	
45332.3.2		CONST	

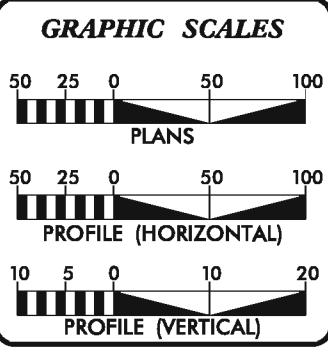
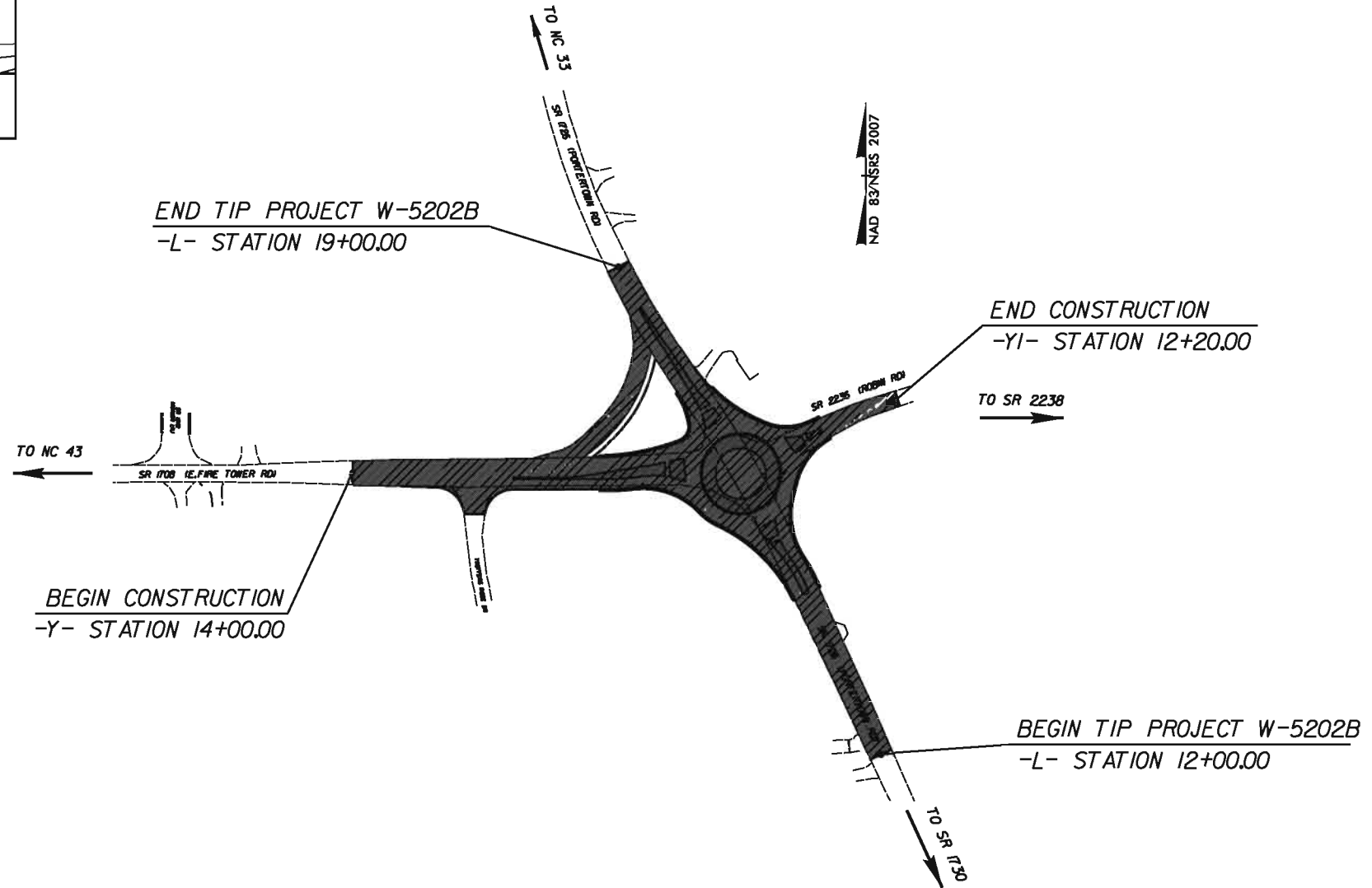

PROJECT LENGTH

LENGTH ROADWAY TIP PROJECT W-5202B = 0.132 MILES

TOTAL LENGTH TIP PROJECT W-5202B = 0.132 MILES

Prepared in the Office of:
DIVISION OF HIGHWAYS
1704 North Greene Street, Greenville NC, 27835

2012 STANDARD SPECIFICATIONS

RIGHT OF WAY DATE: DWAYNE H. ALLIGOOD
PROJECT ENGINEER

LETTING DATE: MAY 2012

LANG JONES
PROJECT DESIGN ENGINEER

HYDRAULICS ENGINEER

Dwayne H. Alligood
 SIGNATURE: *Dwayne H. Alligood* 7/05/2012

ROADWAY DESIGN ENGINEER

Dwayne H. Alligood
 SIGNATURE: *Dwayne H. Alligood* 7/05/2012

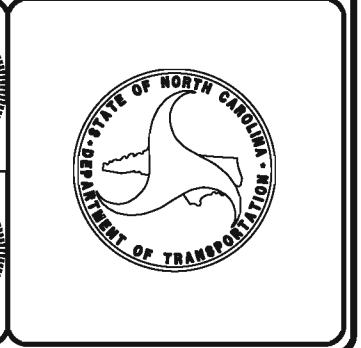

07-MAY-2012 13:45 C:\PROJECTS\PITT\FIRE TOWER_PORTERTOWN\Revised\Fp_roundabout_psh.Ldgn \$\$\$USERNAME\$\$\$

INDEX OF SHEETS

SHEET NUMBER	SHEET
1	TITLE SHEET
1A	INDEX OF SHEETS, GENERAL NOTES, STANDARD DRAWINGS
1B	CONVENTIONAL SYMBOLS
2	TYPICAL SECTIONS
3	SUMMARY OF QUANTITIES
3A	SUMMARY OF DRAINAGE QUANTITIES, EARTHWORK & PAVEMENT REMOVAL
4	PLAN SHEET
4A	RIGHT OF WAY SHEET
5	PROFILE SHEET
PM1	PAVEMENT MARKING AND SPLITTER ISLAND DETAILS
TCP1-TCP2	TRAFFIC CONTROL PLAN SHEETS
EC1-EC3	EROSION CONTROL SHEETS
U01-U02	UTILITIES BY OTHERS
X1A	CROSS-SECTION SUMMARY
X1-X3	CROSS-SECTIONS

GENERAL NOTES:

2012 SPECIFICATIONS
EFFECTIVE: 01-17-12
REVISED: 11-01-11

GRADING AND SURFACING OR RESURFACING AND WIDENING:

THE GRADE LINES SHOWN DENOTE THE FINISHED ELEVATION OF THE PROPOSED SURFACING AT GRADE POINTS SHOWN ON THE TYPICAL SECTIONS. WHERE NO GRADE LINES ARE SHOWN, THE PROFILES SHOWN DENOTE THE TOP ELEVATION OF THE EXISTING PAVEMENT ALONG THE CENTER LINE OF SURVEY ON WHICH THE PROPOSED RESURFACING WILL BE PLACED. GRADE LINES MAY BE ADJUSTED BY THE ENGINEER IN ORDER TO SECURE A PROPER TIE-IN.

GRADING:

THE GRADE LINES SHOWN DENOTE THE FINISHED ELEVATION OF THE PROPOSED OR FUTURE SURFACING AT GRADE POINTS SHOWN ON THE TYPICAL SECTIONS. GRADE LINES MAY BE ADJUSTED AT THEIR BEGINNING AND ENDING AND AT STRUCTURES AS DIRECTED BY THE ENGINEER IN ORDER TO SECURE A PROPER TIE-IN.

SUPERELEVATION:

ALL CURVES ON THIS PROJECT SHALL BE SUPERELEVATED IN ACCORDANCE WITH STD. NO. 225.04 USING THE RATE OF SUPERELEVATION AND RUNOFF SHOWN ON THE PLANS.

SUPERELEVATION IS TO BE REVOLVED ABOUT THE GRADE POINTS SHOWN ON THE TYPICAL SECTIONS.

SHOULDER CONSTRUCTION:

ASPHALT, EARTH, AND CONCRETE SHOULDER CONSTRUCTION ON THE HIGH SIDE OF SUPERELEVATED CURVES SHALL BE IN ACCORDANCE WITH STD. NO. 560.01.

SIDE ROADS:

THE CONTRACTOR WILL BE REQUIRED TO DO ALL NECESSARY WORK TO PROVIDE SUITABLE CONNECTIONS WITH ALL ROADS, STREETS, AND DRIVES ENTERING THIS PROJECT. THIS WORK WILL BE PAID FOR AT THE CONTRACT UNIT PRICE FOR THE PARTICULAR ITEMS INVOLVED.

UTILITIES:

ALL EXISTING UTILITIES SHOWN ON PLANS ARE APPROXIMATE.

UTILITY OWNERS ON THIS PROJECT ARE AS FOLLOWS:

CENTURYLINK (PHONE/FIBER) - CONTACT: PAM ISLES PHONE: 252-355-4544
CENTURYLINK TO BE INCLUDED IN PRECONSTRUCTION MEETING.

EASTERN PINES WATER CORP. - CONTACT: BARRY SUTTON PHONE: 252-752-7420
WATER LINES SHALL BE RELOCATED PRIOR TO CONSTRUCTION.

GUC (POWER) - CONTACT: JEFF OAKLEY PHONE: 252-551-1584 EMAIL: OAKLEYJ@GUC.COM
POWER POLES SHALL BE RELOCATED PRIOR TO CONSTRUCTION.

GUC (GAS) - CONTACT: CHARLES BUCK PHONE: 252-551-1593 EMAIL: BUCKCR@GUC.COM
CONTACT: JASON CYPHERS PHONE: SAME EMAIL: CYPHERJA@GUC.COM
GAS WILL BE RELOCATED DURING CONSTRUCTION.
GUC (GAS) TO BE INCLUDED IN PRECONSTRUCTION MEETING.

SUDDENLINK (CATV) - CONTACT:

RIGHT-OF-WAY MARKERS:

ALL RIGHT-OF-WAY MARKERS ON THIS PROJECT SHALL BE PLACED BY OTHERS.

2012 ROADWAY ENGLISH STANDARD DRAWINGS

The following Roadway Standards as appear in "Roadway Standard Drawings" Highway Design Branch - N. C. Department of Transportation - Raleigh, N. C., Dated January, 2012 are applicable to this project and by reference hereby are considered a part of these plans.

STD. NO. TITLE

DIVISION 2 - EARTHWORK
200.02 Method of Clearing - Method II
225.02 Guide for Grading Subgrade - Secondary and Local
225.04 Method of Obtaining Superelevation - Two Lane Pavement

DIVISION 3 - PIPE CULVERTS
300.01 Method of Pipe Installation - Method 'A'

DIVISION 5 - SUBGRADE, BASES AND SHOULDERS
560.01 Method of Shoulder Construction - High Side of Superelevated Curve - Method I

DIVISION 8 - INCIDENTALS
840.02 Concrete Catch Basin - 12" thru 54" Pipe
840.03 Frame, Grates and Hood - for Use on Standard Catch Basin
840.14 Concrete Drop Inlet - 12" thru 30" Pipe
840.29 Frame and Narrow Slot Flat Grates

846.01 Concrete Curb, Gutter and Curb & Gutter
848.01 Concrete Sidewalk
852.01 Concrete Islands

Note: Not to Scale
 *S.U.E. = *Subsurface Utility Engineering*

STATE OF NORTH CAROLINA
 DIVISION OF HIGHWAYS

CONVENTIONAL PLAN SHEET SYMBOLS

BOUNDARIES AND PROPERTY:

State Line	-----
County Line	-----
Township Line	-----
City Line	-----
Reservation Line	-----
Property Line	-----
Existing Iron Pin	⊙
Property Corner	⊙
Property Monument	⊙
Parcel/Sequence Number	②③
Existing Fence Line	-x-x-x-
Proposed Woven Wire Fence	○
Proposed Chain Link Fence	□
Proposed Barbed Wire Fence	◇
Existing Wetland Boundary	-----
Proposed Wetland Boundary	-----
Existing Endangered Animal Boundary	-----
Existing Endangered Plant Boundary	-----

BUILDINGS AND OTHER CULTURE:

Gas Pump Vent or U/G Tank Cap	○
Sign	⊙
Well	⊙
Small Mine	⊗
Foundation	▭
Area Outline	▭
Cemetery	⊕
Building	▭
School	⊕
Church	⊕
Dam	▭

HYDROLOGY:

Stream or Body of Water	-----
Hydro, Pool or Reservoir	▭
Jurisdictional Stream	-----
Buffer Zone 1	-----
Buffer Zone 2	-----
Flow Arrow	←
Disappearing Stream	-----
Spring	⊙
Wetland	-----
Proposed Lateral, Tail, Head Ditch	-----
False Sump	-----

RAILROADS:

Standard Gauge	-----
RR Signal Milepost	⊙
Switch	⊙
RR Abandoned	-----
RR Dismantled	-----

RIGHT OF WAY:

Baseline Control Point	◆
Existing Right of Way Marker	△
Existing Right of Way Line	-----
Proposed Right of Way Line	-----
Proposed Right of Way Line with Iron Pin and Cap Marker	-----
Proposed Right of Way Line with Concrete or Granite Marker	-----
Existing Control of Access	⊙
Proposed Control of Access	⊙
Existing Easement Line	-----
Proposed Temporary Construction Easement	-----
Proposed Temporary Drainage Easement	-----
Proposed Permanent Drainage Easement	-----
Proposed Permanent Utility Easement	-----
Proposed Temporary Utility Easement	-----
Proposed Permanent Easement with Iron Pin and Cap Marker	-----

ROADS AND RELATED FEATURES:

Existing Edge of Pavement	-----
Existing Curb	-----
Proposed Slope Stakes Cut	-----
Proposed Slope Stakes Fill	-----
Proposed Wheel Chair Ramp	-----
Existing Metal Guardrail	-----
Proposed Guardrail	-----
Existing Cable Guiderail	-----
Proposed Cable Guiderail	-----
Equality Symbol	⊕
Pavement Removal	-----

VEGETATION:

Single Tree	⊙
Single Shrub	⊙
Hedge	-----
Woods Line	-----
Orchard	-----
Vineyard	-----

EXISTING STRUCTURES:

MAJOR:	
Bridge, Tunnel or Box Culvert	-----
Bridge Wing Wall, Head Wall and End Wall	-----
MINOR:	
Head and End Wall	-----
Pipe Culvert	-----
Footbridge	-----
Drainage Box: Catch Basin, DI or JB	-----
Paved Ditch Gutter	-----
Storm Sewer Manhole	⊙
Storm Sewer	-----

UTILITIES:

POWER:	
Existing Power Pole	⊙
Proposed Power Pole	⊙
Existing Joint Use Pole	⊙
Proposed Joint Use Pole	⊙
Power Manhole	⊙
Power Line Tower	⊗
Power Transformer	⊗
U/G Power Cable Hand Hole	⊙
H-Frame Pole	⊙
Recorded U/G Power Line	-----
Designated U/G Power Line (S.U.E.*)	-----

TELEPHONE:

Existing Telephone Pole	⊙
Proposed Telephone Pole	⊙
Telephone Manhole	⊙
Telephone Booth	⊙
Telephone Pedestal	⊙
Telephone Cell Tower	⊙
U/G Telephone Cable Hand Hole	⊙
Recorded U/G Telephone Cable	-----
Designated U/G Telephone Cable (S.U.E.*)	-----
Recorded U/G Telephone Conduit	-----
Designated U/G Telephone Conduit (S.U.E.*)	-----
Recorded U/G Fiber Optics Cable	-----
Designated U/G Fiber Optics Cable (S.U.E.*)	-----

WATER:

Water Manhole	⊙
Water Meter	⊙
Water Valve	⊙
Water Hydrant	⊙
Recorded U/G Water Line	-----
Designated U/G Water Line (S.U.E.*)	-----
Above Ground Water Line	-----

TV:

TV Satellite Dish	⊙
TV Pedestal	⊙
TV Tower	⊙
U/G TV Cable Hand Hole	⊙
Recorded U/G TV Cable	-----
Designated U/G TV Cable (S.U.E.*)	-----
Recorded U/G Fiber Optic Cable	-----
Designated U/G Fiber Optic Cable (S.U.E.*)	-----

GAS:

Gas Valve	⊙
Gas Meter	⊙
Recorded U/G Gas Line	-----
Designated U/G Gas Line (S.U.E.*)	-----
Above Ground Gas Line	-----

SANITARY SEWER:

Sanitary Sewer Manhole	⊙
Sanitary Sewer Cleanout	⊙
U/G Sanitary Sewer Line	-----
Above Ground Sanitary Sewer	-----
Recorded SS Forced Main Line	-----
Designated SS Forced Main Line (S.U.E.*)	-----

MISCELLANEOUS:

Utility Pole	⊙
Utility Pole with Base	⊙
Utility Located Object	⊙
Utility Traffic Signal Box	⊙
Utility Unknown U/G Line	-----
U/G Tank; Water, Gas, Oil	-----
AG Tank; Water, Gas, Oil	-----
U/G Test Hole (S.U.E.*)	⊙
Abandoned According to Utility Records	AATUR
End of Information	E.O.I.

PROJECT REFERENCE NO. W-5202B	SHEET NO. 2
ROADWAY DESIGN ENGINEER 	PAVEMENT DESIGN ENGINEER

PAVEMENT SCHEDULE

C1	PROP. APPROX. 3" ASPHALT CONCRETE SURFACE COURSE, TYPE S9.5B, AT AN AVERAGE RATE OF 336 LBS. PER SQ. YD.
C2	PROP. APPROX. 1 1/2" ASPHALT CONCRETE SURFACE COURSE, TYPE S9.5B, AT AN AVERAGE RATE OF 168 LBS. PER SQ. YD.
D1	PROP. APPROX. 4" ASPHALT CONCRETE INTERMEDIATE COURSE, TYPE I19.0B, AT AN AVERAGE RATE OF 456 LBS. PER SQ. YD.
D2	PROPOSED VARIABLE DEPTH ASPHALT CONCRETE INTERMEDIATE COURSE, TYPE I19.0B, AN AVERAGE RATE OF 114 LBS. PER SQ. YD. PER 1" DEPTH.
E1	PROP. APPROX. 4" ASPHALT CONCRETE BASE COURSE. TYPE B25.0B, AT AN AVERAGE RATE OF 456 LBS. PER SQ. YD.
J1	PROP. APPROX. 10" AGGREGATE BASE COURSE
R1	PROP. 2'-6" CONCRETE CURB AND GUTTER.
R2	PROP. 1'-6" CONCRETE CURB AND GUTTER.
R3	PROP. 6" CONCRETE APRON.
R4	PROP. 5" CONCRETE MONOLITHIC ISLAND (SURFACE MOUNTED).
S	FUTURE 4" CONCRETE SIDEWALK
T	EARTH MATERIAL.
U	EXISTING PAVEMENT

NOTE: PAVEMENT EDGE SLOPES ARE 1:1 UNLESS SHOWN OTHERWISE.

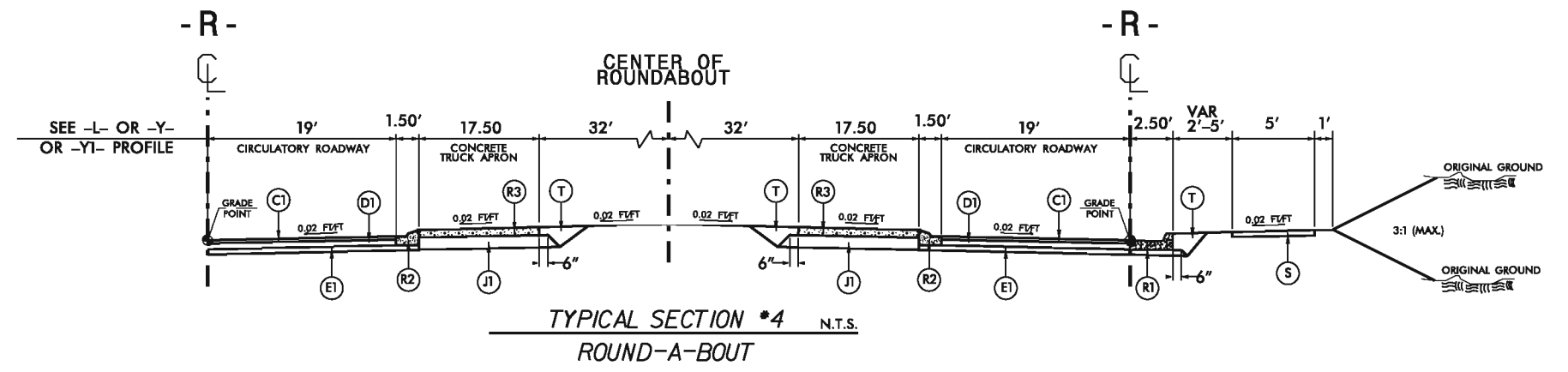
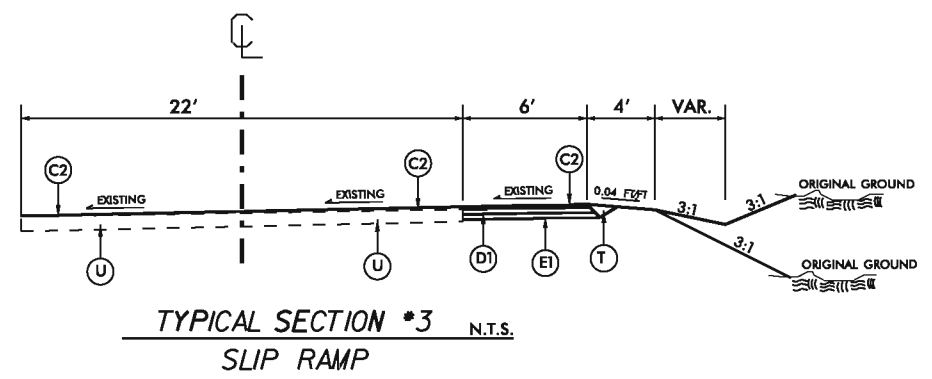
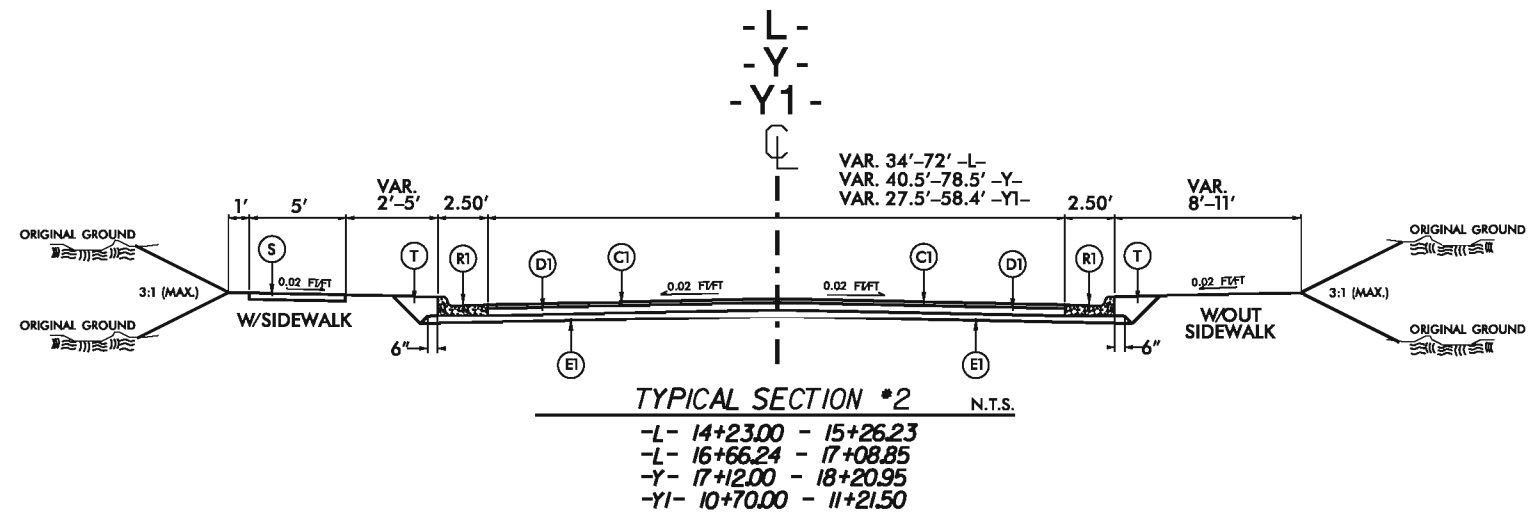
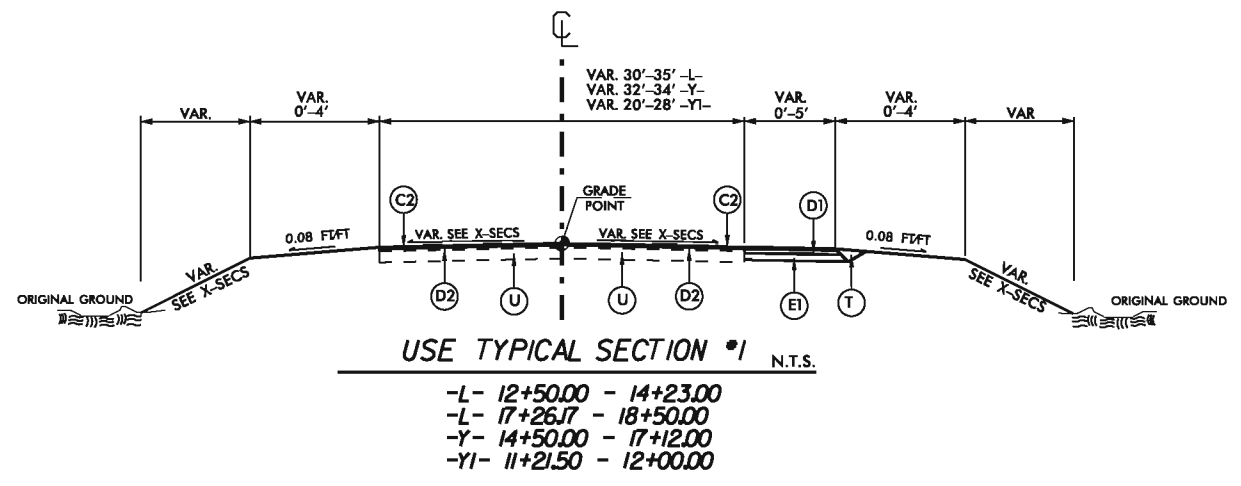
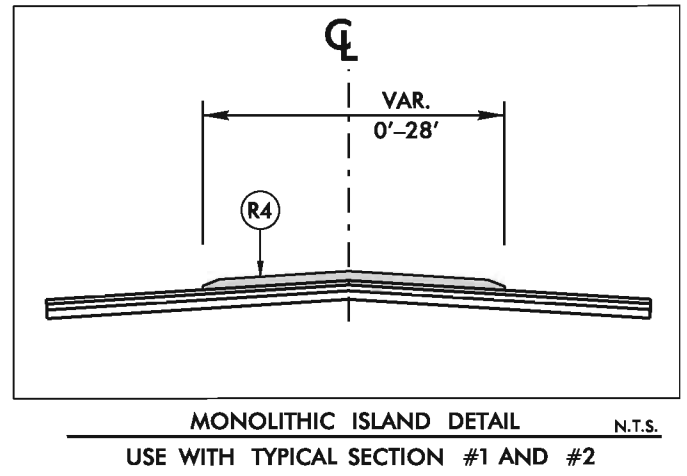

STATE OF NORTH CAROLINA DIVISION OF HIGHWAYS SUMMARY OF QUANTITIES

ITEM	SECT	QUANTITY	UNIT	ITEM DESCRIPTION
1	800	1	LS	MOBILIZATION
2	226	1	LS	GRADING
3	226	200	CY	UNDERCUT EXCAVATION
4	300	100	TON	FOUNDATION CONDITIONING MATERIAL, MINOR STRUCTURES
5	300	290	SY	FOUNDATION CONDITIONING GEOTEXTILE
6	310	424	LF	15" RC PIPE CULVERTS, CLASS III
7	310	288	LF	18" RC PIPE CULVERTS, CLASS III
8	310	142	LF	24" RC PIPE CULVERTS, CLASS III
9	340	54	LF	PIPE REMOVAL
10	520	340	TON	AGGREGATE BASE COURSE
11	545	200	TON	INCIDENTAL STONE BASE
12	610	715	TON	ASPHALT CONCRETE BASE COURSE, TYPE B25.0B
13	610	900	TON	ASPHALT CONCRETE INTERMEDIATE COURSE, TYPE I19.0B
14	610	830	TON	ASPHALT CONCRETE SURFACE COURSE, TYPE S9.5B
15	620	125	TON	ASPHALT BINDER FOR PLANT MIX, GRADE PG64-22
16	840	10	EA	MASONRY DRAINAGE STRUCTURES
17	840	3	EA	FRAME WITH GRATE, STD 840.29
18	840	2	EA	FRAME WITH GRATE AND HOOD, STD 840.03, TYPE E
19	840	3	EA	FRAME WITH GRATE AND HOOD, STD 840.03, TYPE F
20	840	2	EA	FRAME WITH GRATE AND HOOD, STD 840.03, TYPE G
21	846	325	LF	1'-6" CONCRETE CURB & GUTTER
22	846	870	LF	2'-6" CONCRETE CURB & GUTTER
23	852	810	SY	5" MONOLITHIC ISLANDS (SURFACE MOUNTED)
24	SP	500	SY	6" CONCRETE TRUCK APRON
25	858	1	EA	ADJUSTMENT OF MANHOLES
26	1105	1	LS	TEMPORARY TRAFFIC CONTROL
27	1205	1730	LF	THERMOPLASTIC PAVEMENT MARKING LINES (4", 90 MILS)
28	1205	2850	LF	THERMOPLASTIC PAVEMENT MARKING LINES (4", 120 MILS)
29	1205	80	LF	THERMOPLASTIC PAVEMENT MARKING LINES (12", 120 MILS)
30	1205	20	EA	THERMOPLASTIC PAVEMENT MARKING CHARACTERS (120 MILS)
31	1205	5	EA	THERMOPLASTIC PAVEMENT MARKING SYMBOL (90 MILS)
32	1205	22	EA	THERMOPLASTIC PAVEMENT MARKING SYMBOL (120 MILS)
33	1605	1000	LF	TEMPORARY SILT FENCE
34	1610	10	TON	SEDIMENT CONTROL STONE
35	1615	1	ACRE	TEMPORARY MULCHING
36	1620	50	LB	SEED FOR TEMPORARY SEEDING
37	1620	0.2	TON	FERTILIZER FOR TEMPORARY SEEDING
38	1631	500	SY	MATTING FOR EROSION CONTROL
39	1632	380	LF	1/4" HARDWARE CLOTH
40	SP	180	LF	WATTLE
41	SP	10	LB	POLYACRYLAMIDE (PAM)
42	1660	1	ACRE	SEEDING AND MULCHING
43	1661	50	LB	SEED FOR REPAIR SEEDING
44	1661	0.2	TON	FERTILIZER FOR REPAIR SEEDING

8/17/99

07-MAY-2012 13:46 G:\PROJ\ECIS\11\FIRE TOWER-PORTERTOWN\Revised\Fp-roundabout.psh_4.dgn

REVISIONS

PROJECT REFERENCE NO. W-5202B		SHEET NO. 4	
RAW SHEET NO.			
ROADWAY DESIGN ENGINEER		HYDRAULICS ENGINEER	

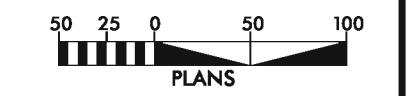

LEGEND:

FUTURE SIDEWALK

NAD 83/NSRS 2007

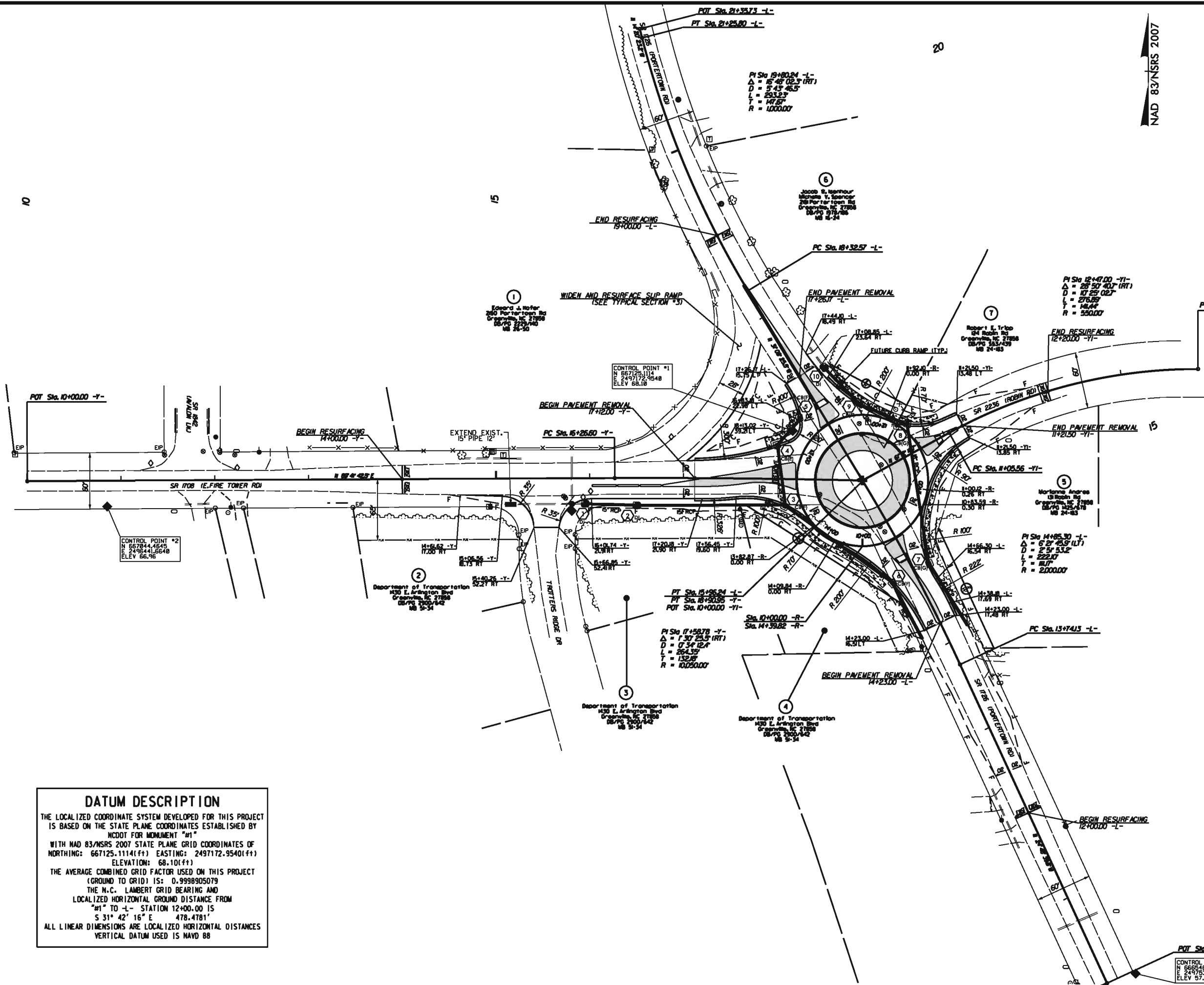

DATUM DESCRIPTION

THE LOCALIZED COORDINATE SYSTEM DEVELOPED FOR THIS PROJECT IS BASED ON THE STATE PLANE COORDINATES ESTABLISHED BY NCDOT FOR MONUMENT "M1" WITH NAD 83/NSRS 2007 STATE PLANE GRID COORDINATES OF NORTHING: 667125.1114(ft) EASTING: 2497172.9540(ft) ELEVATION: 68.10(ft)

THE AVERAGE COMBINED GRID FACTOR USED ON THIS PROJECT (GROUND TO GRID) IS: 0.9998905079

THE N.C. LAMBERT GRID BEARING AND LOCALIZED HORIZONTAL GROUND DISTANCE FROM "M1" TO -L- STATION 12+00.00 IS S 31° 42' 16" E 478.4781'

ALL LINEAR DIMENSIONS ARE LOCALIZED HORIZONTAL DISTANCES VERTICAL DATUM USED IS NAVD 88

POT Sta. 10+00.00 -L-
CONTROL POINT #3
N 666546.6388
E 2497336.5348
ELEV 57.14

8/17/99

RIGHT OF WAY AREA SUMMARY

PARCEL NO.	PROPERTY OWNER NAME	LOCATION	TOTAL PARCEL AREA [ACRES]	AREA TO BE DEDICATED (PERMANENT UTILITY EASEMENT) [ACRES]	AREA TO BE DEDICATED (RIGHT OF WAY) [ACRES]	PARCEL AREA REMAINING [ACRES]
2	DEPARTMENT OF TRANSPORTATION	RT -Y-	0.46	0.14	0.00	0.32
3	DEPARTMENT OF TRANSPORTATION	RT -Y-	0.46	0.14	0.00	0.32
4	DEPARTMENT OF TRANSPORTATION	RT -Y-	0.49	0.10	0.13	0.25
5	MARIANNE ANDRES	RT -L-	0.85		0.03	0.82
6	JACOB W. ISENHOUR	RT -L-	1.64		0.06	1.58
7	ROBERT E. TRIPP	RT -L-		0.01		

PROJECT REFERENCE NO. W-5202B	SHEET NO. 4A
RAW SHEET NO.	
ROADWAY DESIGN ENGINEER 	HYDRAULICS ENGINEER

NAD 83/NSRS 2007



LEGEND:

FUTURE SIDEWALK

REVISIONS

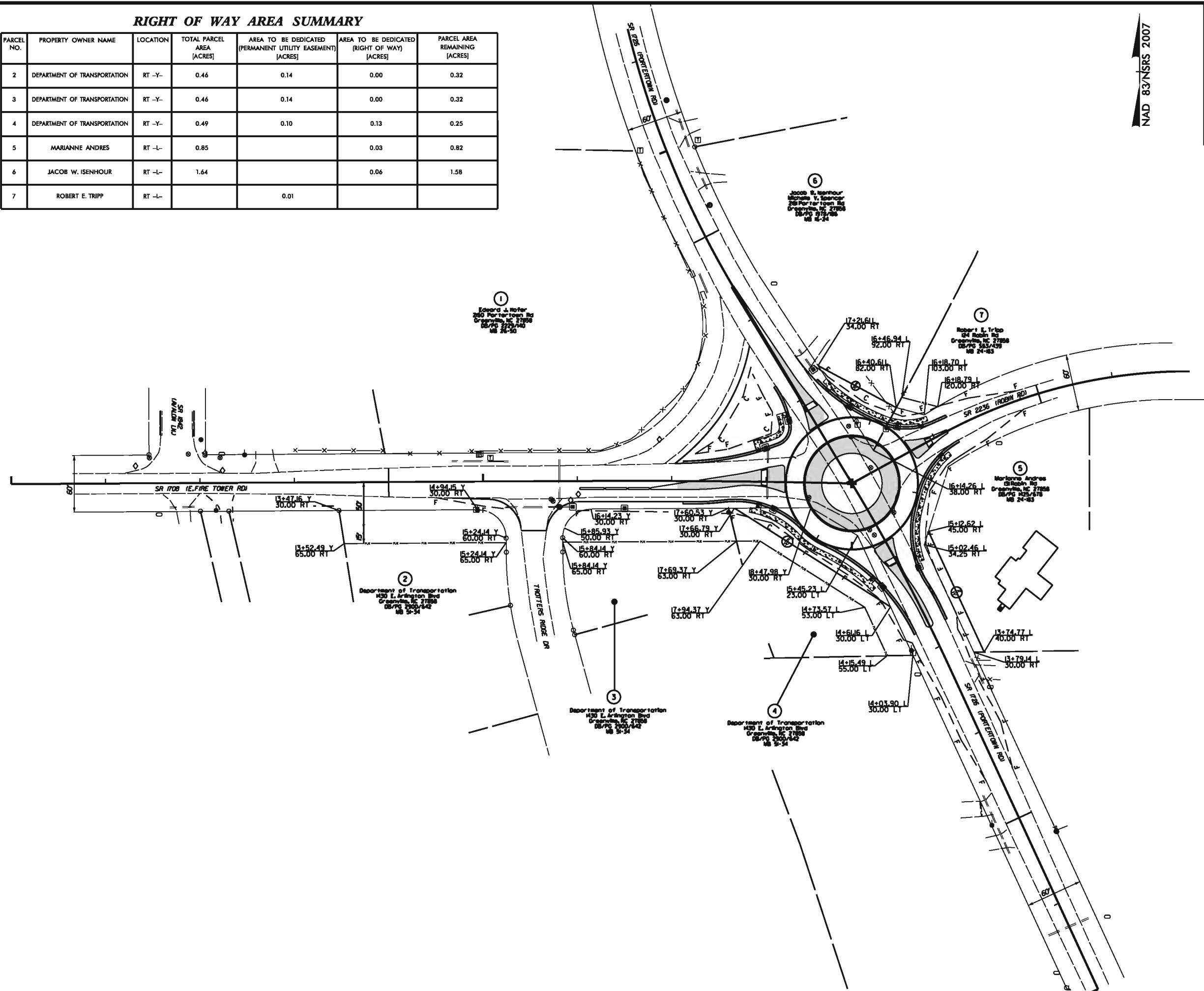

07-MAY-2012 13:46
 G:\PROJECTS\1708 FIRE TOWER\PORTERTOWN\Revised\Fp-roundabout.psh_4a.dgn
 \$\$\$SUSHERNAME\$\$\$

5/14/99

07-MAY-2012 13:46
C:\PROJECTS\12\FIRE TOWER_PORTERTOWN\Revised\Fp-roundabout.psh_5.dgn

10 11 12 13 14 15 16 17 18 19 20 21

PROJECT REFERENCE NO. W-5202B	SHEET NO. 5
ROADWAY DESIGN ENGINEER 	HYDRAULICS ENGINEER

-R- PROFILE
SCALE: 1"=50' HORIZ.
1"=10' VERT.

LOW POINT
PI = 10+00.00
EL = 66.00
VC = 150'
K = 64

HIGH POINT
PI = 12+57.96
EL = 68.50
VC = 150'
K = 64

LOW POINT
PI = 14+39.82
EL = 66.00
VC = 150'
K = 64

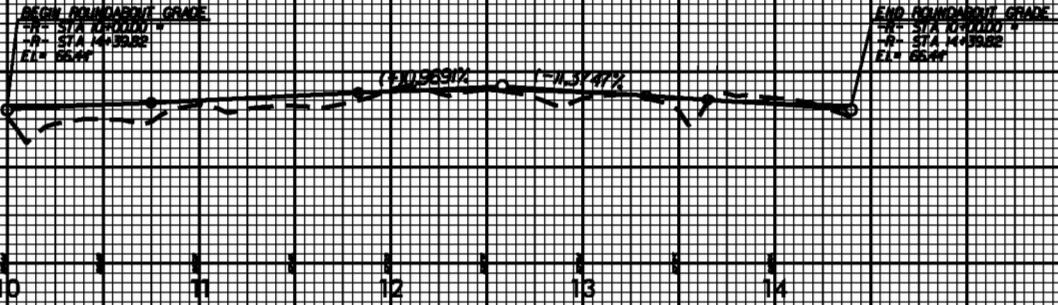

-L- PROFILE
SCALE: 1"=50' HORIZ.
1"=10' VERT.

PI = 13+50.00
EL = 61.75
VC = 150'
K = 118

PI = 15+26.23
EL = 65.47

PI = 16+66.24
EL = 68.06

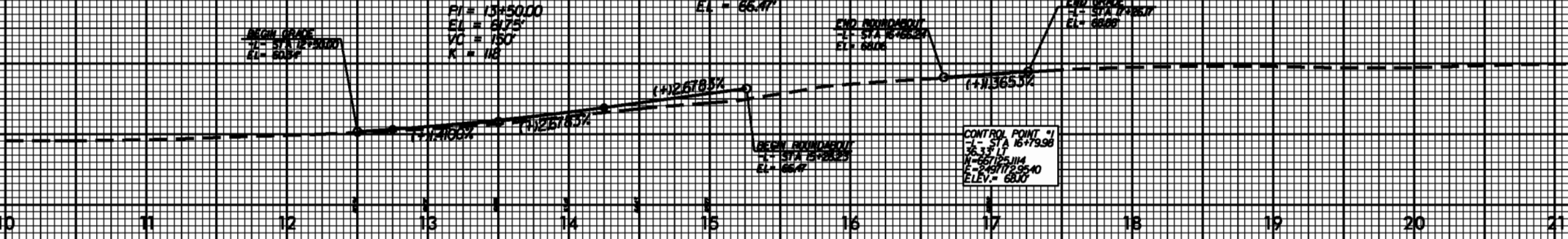

-Y- PROFILE
SCALE: 1"=50' HORIZ.
1"=10' VERT.

PI = 17+50.00
EL = 68.25

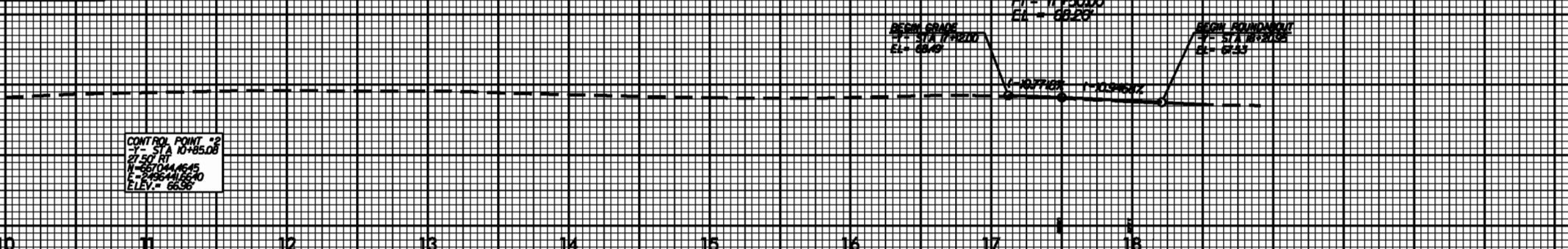

-YI- PROFILE
SCALE: 1"=50' HORIZ.
1"=10' VERT.

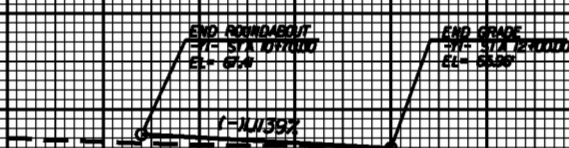

10 11 12 13 14 15 16 17 18 19 20 21 22 23

8/17/99

PAVEMENT MARKING SCHEDULE

PAVEMENT MARKING LINES

- AA - THERMOPLASTIC (1/2" WHITE, 120 MILS) 12" X 3" MINI SKIP
- AB - THERMOPLASTIC (4" WHITE, 120 MILS) 4" X 3" MINI SKIP
- AC - THERMOPLASTIC (4" WHITE, 120 MILS) 4" X 2" MINI SKIP
- AD - THERMOPLASTIC (4" WHITE, 120 MILS) SOLID LANE LINE
- AE - THERMOPLASTIC (4" YELLOW, 120 MILS) SOLID LANE LINE
- AG - THERMOPLASTIC (4" YELLOW, 120 MILS) SOLID DOUBLE YELLOW
- AH - THERMOPLASTIC (4" YELLOW, 90 MILS) EDGE LINE
- AI - THERMOPLASTIC (4" WHITE, 90 MILS) EDGE LINE

PAVEMENT MARKING SYMBOLS

- BA - THERMOPLASTIC (STRAIGHT / LEFT ARROW, 90 MILS)
- BB - THERMOPLASTIC (LEFT ARROW, 90 MILS)
- BC - THERMOPLASTIC (CHARACTERS, 120 MILS)
- BD - THERMOPLASTIC (YIELD LINE, 120 MILS)

NOTES

PAINT MARKINGS AND TRAFFIC CONTROL DEVICES SHALL BE IN ACCORDANCE WITH NCDOT STANDARD SPECIFICATIONS FOR ROADS AND STRUCTURES, NCDOT ROADWAY STANDARD DRAWINGS, AND THE CURRENT EDITION OF THE MANUAL OF UNIFORM TRAFFIC CONTROL DEVICES (MUTCD). QUANTITIES FOR THESE ITEMS HAVE BEEN ACCOUNTED FOR IN THE CONTRACT BID FORM.

STATE FORCES SHALL INSTALL SIGNING.

PROJECT REFERENCE NO. W-5202B	SHEET NO. PMI
RAW SHEET NO.	
ROADWAY DESIGN ENGINEER 	HYDRAULICS ENGINEER

NAD 83/NSRS 2007

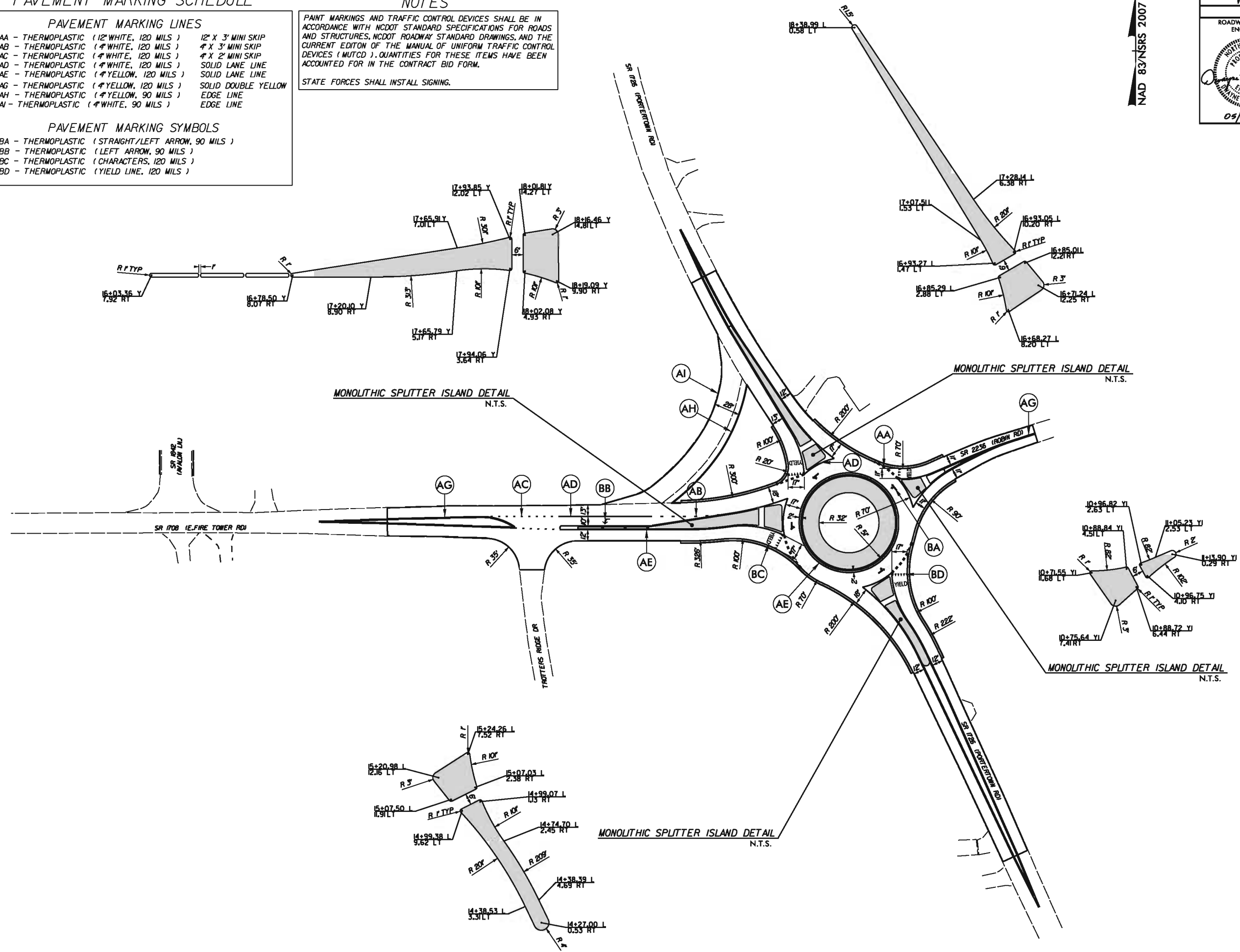

REVISIONS

07-MAY-2012 13:46 G:\PROJECTS\1708 FIRE TOWER\PORTERTOWN\Revised\Fp-roundabout.psh.pml.dgn

STATE OF NORTH CAROLINA
DIVISION OF HIGHWAYS

STATE PROJECT REFERENCE NO.	SHEET NO.
W-5202B	TCP-1

**PLAN FOR PROPOSED
TRAFFIC CONTROL**

PITT COUNTY

ROADWAY STANDARD DRAWINGS

THE FOLLOWING ROADWAY STANDARDS AS APPEAR IN "ROADWAY STANDARD DRAWINGS" - HIGHWAY DESIGN BRANCH-N.C. DEPARTMENT OF TRANSPORTATION-RALEIGH, N.C., DATED JULY 2006 ARE APPLICABLE TO THIS PROJECT AND BY REFERENCE HEREBY ARE CONSIDERED A PART OF THESE PLANS:

STD. NO.	TITLE
1101.02	TEMPORARY LANE CLOSURES
1101.11	TRAFFIC CONTROL DESIGN TABLES
1110.01	STATIONARY WORK ZONE SIGNS
1145.01	BARRICADES (TYPE III)

INDEX OF SHEETS

SHEET NO.	TITLE
TCP-1	LIST OF APPLICABLE ROADWAY STANDARD DRAWINGS, LEGEND, AND INDEX OF SHEETS
TCP-2	PROJECT NOTES, DETOUR, PHASING AND PLANS

LEGEND

- GENERAL**
- DIRECTION OF TRAFFIC FLOW
 - NORTH ARROW
 - PROPOSED PVMT. EXIST. PVMT.
 - WORK AREA
 - REMOVAL OF EXISTING PAVEMENT
- TRAFFIC CONTROL DEVICES**
- TYPE I BARRICADE
 - TYPE II BARRICADE
 - TYPE III BARRICADE
 - CONE
 - DRUM SKINNY DRUM
 - FLASHING ARROW PANEL (TYPE C)
 - STATIONARY SIGN
 - PORTABLE SIGN
 - STATIONARY OR PORTABLE SIGN
 - CRASH CUSHION
 - CHANGEABLE MESSAGE SIGN
 - TRUCK MOUNTED IMPACT ATTENUATOR (TMIA)
 - POLICE
 - FLAGGER

PROJECT: W-5202B

07-MAY-2012 13:46 G:\PROJECTS\PITT\FIRE TOWER-PORTERTOWN Revised\Fp_roundabout_psh_tcp1.dgn \$\$\$USERNAME\$\$\$

APPROVED: DATE: 6/2/2012	PLAN PREPARED BY: N.C.D.O.T. DIVISION 2 DDC UNIT
SEAL	D. H. ALLIGOOD, PE TRAFFIC CONTROL ENGINEER
	D. H. ALLIGOOD, PE TRAFFIC CONTROL PROJECT ENGINEER
	LANG JONES TRAFFIC CONTROL PROJECT DESIGN ENGINEER
	V. TRAN TRAFFIC CONTROL DESIGN ENGINEER / TECHNICIAN

PHASE 1



1. CLOSE SLIP RAMP.
2. WIDEN SLIP RAMP ACCORDING TO ROADWAY PLANS. COORDINATE PLACEMENT OF TEMPORARY PAVEMENT MARKINGS FOR TWO-WAY TRAFFIC.

PHASE 2

1. DETOUR SIGNING WILL BE INSTALLED.
2. OPEN SLIP RAMP FOR TWO-WAY TRAFFIC PATTERN AND COORDINATE CLOSURE OF INTERSECTION AS SHOWN BELOW.
3. CONSTRUCT PROPOSED ROUNDABOUT WITHIN LIMITS OF CLOSURE. COMPLETE ALL WORK WITH THE EXCEPTION OF (1) THE FINAL SURFACE COURSE AND (2) THE PORTION OF THE SPLITTER ISLANDS LOCATED OUTSIDE OF THE CLOSURE AREA. PROPOSED SPLITTER ISLANDS SHALL BE CONSTRUCTED TO THE OUTERMOST JOINT WITHIN LIMITS OF CLOSURE. 5" MONOLITHIC CONCRETE ISLANDS CONSTRUCTED IN PHASE 2 SHALL BE KEYED IN.
4. PLACE FINAL SURFACE COURSE FOR ENTIRE PROJECT AND PLACE THERMOPLASTIC PAVEMENT MARKING WITHIN LIMITS OF CLOSURE.

PHASE 3

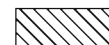
1. OPEN ROUNDABOUT TRAFFIC PATTERN AND REMOVE TEMPORARY TWO-WAY TRAFFIC CONTROL ON SLIP RAMP. STATE FORCES WILL INSTALL INTERIM PAVEMENT MARKINGS OUTSIDE OF THE CLOSURE AREA.
2. DETOUR SIGNING WILL BE REMOVED.
3. CONSTRUCT REMAINING SPLITTER ISLAND SECTIONS UNDER TRAFFIC. 5" MONOLITHIC CONCRETE ISLANDS CONSTRUCTED IN PHASE 3 SHALL BE SURFACE MOUNTED. PHASE 3 WORK SHALL BE PERFORMED AT NIGHT BETWEEN 9PM AND 5AM.
4. CONTRACTOR WILL INSTALL REMAINING THERMOPLASTIC MARKING IN AREA OUTSIDE PHASE 2 CLOSURE AREA.

 PHASE 1 CONSTRUCTION AREA
 PHASE 2 CONSTRUCTION AREA

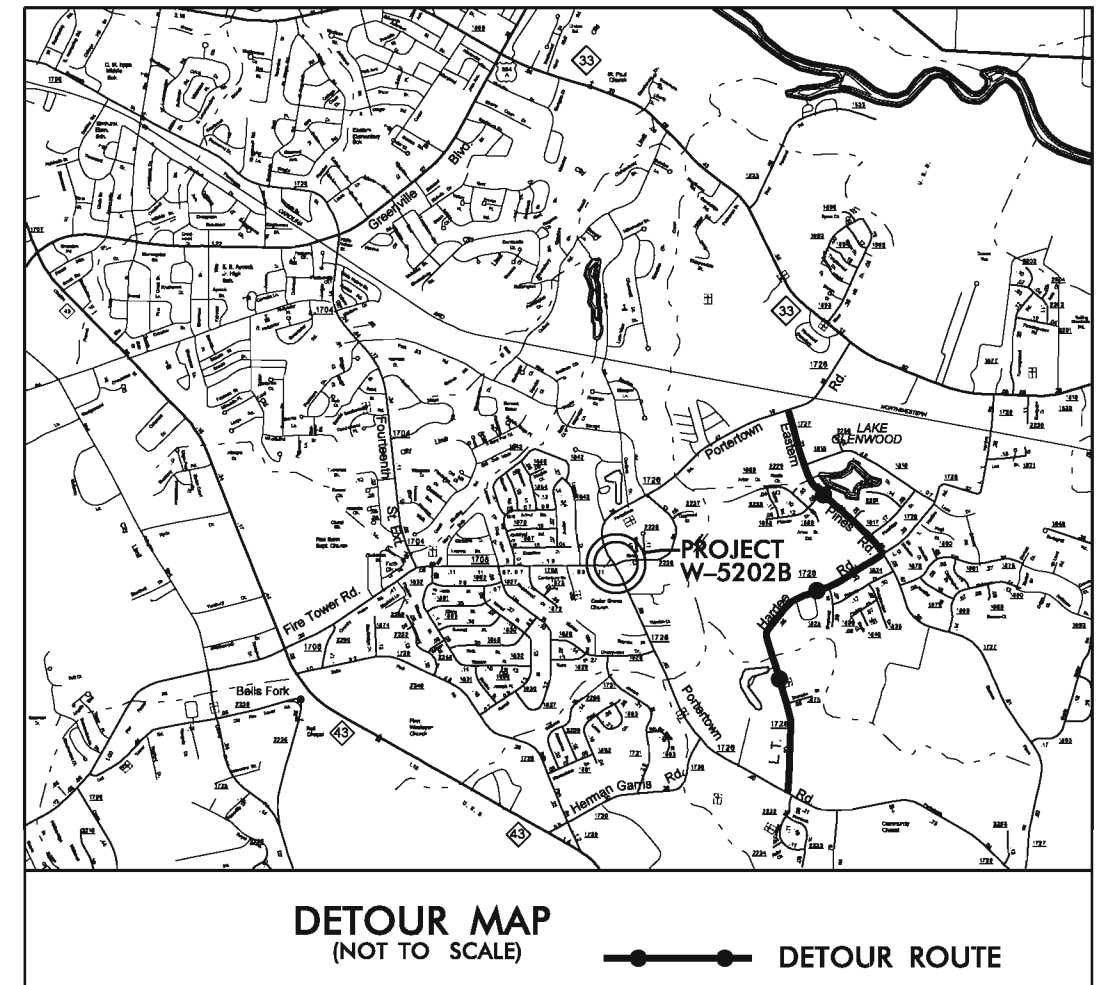
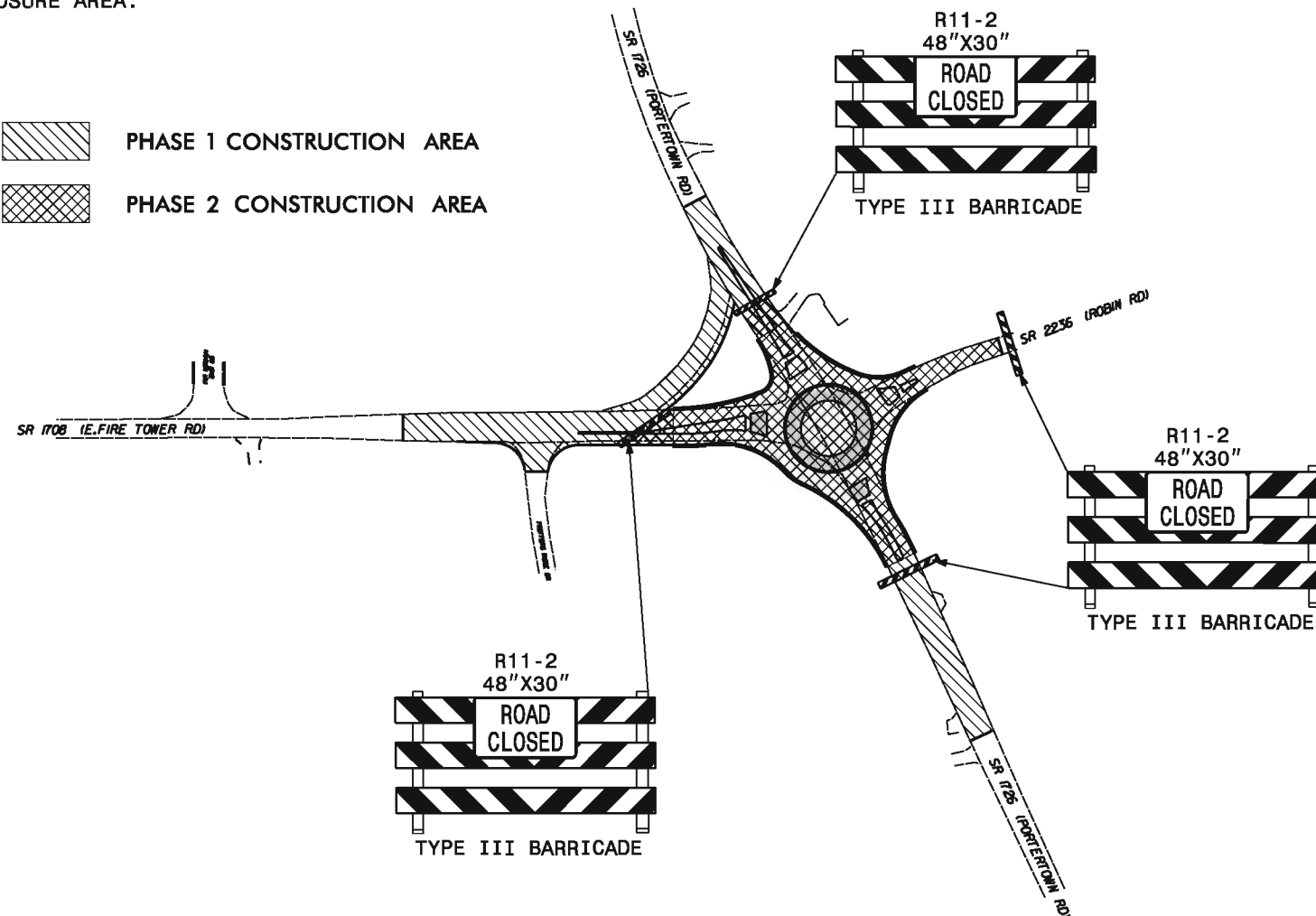

GENERAL NOTES

IMPLEMENT TRAFFIC CONTROL IN ACCORDANCE WITH THE ROADWAY STANDARD DRAWINGS LISTED ON TCP-1.

CHANGES MAY BE REQUIRED WHEN PHYSICAL DIMENSIONS IN THE DETAIL DRAWINGS, STANDARD DETAILS AND ROADWAY DETAILS ARE NOT ATTAINABLE TO MEET FIELD CONDITIONS, OR RESULT IN DUPLICATE, OR UNDESIRABLE OVERLAPPING OF DEVICES. MODIFICATION MAY INCLUDE: MOVING, SUPPLEMENTING, COVERING OR REMOVAL OF DEVICES, AS DIRECTED BY THE ENGINEER.

STATE FORCES WILL INSTALL AND MAINTAIN THE PROJECT DETOUR AND THE TYPE III BARRICADES AT THE PROJECT LIMITS. CALL JIM EVANS AT 252-830-3493 FOR COORDINATION.

APPROVED: <i>Joseph H. Allgood</i>	PROJECT NOTES, DETOUR, PHASING AND PLANS	
		
SCALE: NONE	DATE: 8/2/11	REVISIONS
DWG. BY: LJ	DESIGN BY: LJ	
REVIEWED BY: BB		

09/08/99

TIP PROJECT: W-5202B

See Sheet 1-A For Index of Sheets

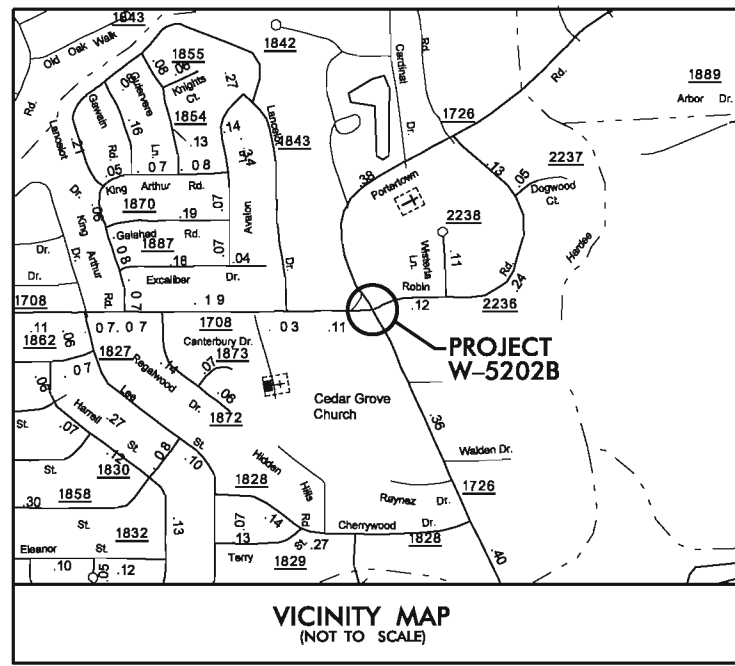

STATE OF NORTH CAROLINA
DIVISION OF HIGHWAYS

PITT COUNTY

PLAN FOR PROPOSED HIGHWAY EROSION CONTROL

STATE	STATE PROJECT REFERENCE NO.	SHEET NO.	TOTAL SHEETS
N.C.	W-5202B	EC1	
STATE PROJ. NO.	F.A. PROJ. NO.	DESCRIPTION	
45332.1.2		PE	
45332.2.2		RW	
45332.3.2		CONST	

Std. #	Description	Symbol
1605.01	High Vis Temporary Silt Fence	
1632.03	Rock Inlet Sediment Trap Type C	
8P	Wattle with Polyacrylamide	
8P	Wattle	

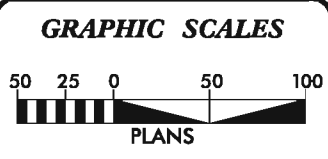
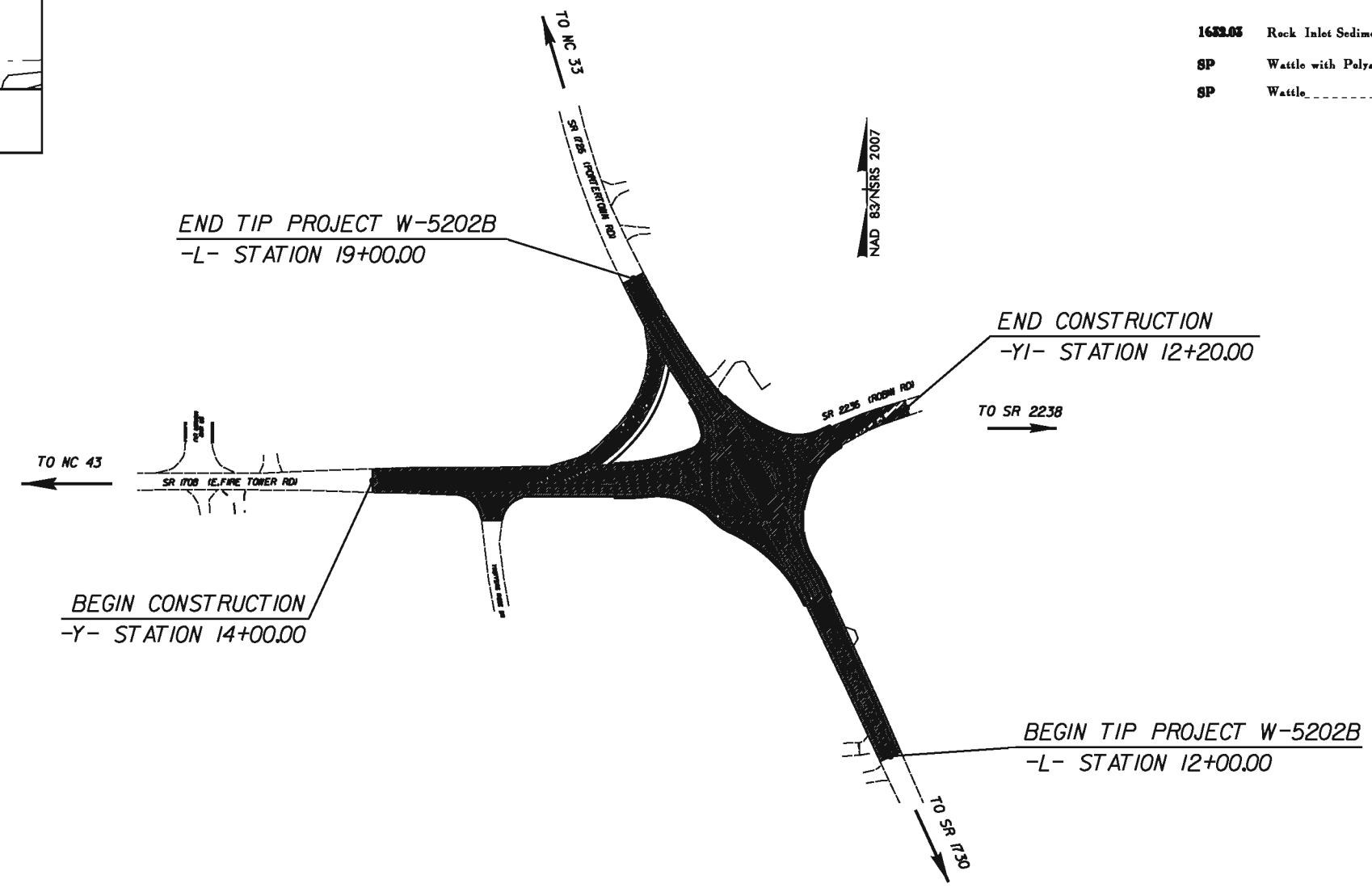

PROJECT LENGTH

LENGTH ROADWAY TIP PROJECT W-5202B = 0.132 MILES

TOTAL LENGTH TIP PROJECT W-5202B = 0.132 MILES

THESE EROSION AND SEDIMENT CONTROL PLANS COMPLY WITH THE REGULATIONS SET FORTH BY THE NCG-010000 GENERAL CONSTRUCTION PERMIT EFFECTIVE AUGUST 3, 2011 ISSUED BY THE NORTH CAROLINA DEPARTMENT OF ENVIRONMENT AND NATURAL RESOURCES DIVISION OF WATER QUALITY.

Prepared in the Office of:
DIVISION OF HIGHWAYS
1704 North Greene Street, Greenville NC, 27835

2012 STANDARD SPECIFICATIONS

RIGHT OF WAY DATE: _____

LETTING DATE: MAY 2012

DWAYNE H. ALLIGOOD
PROJECT ENGINEER

LANG JONES (#276)
PROJECT DESIGN ENGINEER

Roadway Standard Drawings

The following roadway english standards as appear in "Roadway Standard Drawings"- Roadway Design Unit - N. C. Department of Transportation - Raleigh, N. C., dated July 18, 2006 and the latest revision thereto are applicable to this project and by reference hereby are considered a part of these plans.

1604.01 Railroad Erosion Control Detail	1630.06 Special Stilling Basin
1605.01 Temporary Silt Fence	1632.01 Rock Inlet Sediment Trap Type A
1606.01 Special Sediment Control Fence	1632.02 Rock Inlet Sediment Trap Type B
1607.01 Gravel Construction Entrance	1632.03 Rock Inlet Sediment Trap Type C
1622.01 Temporary Berms and Slope Drains	1633.01 Temporary Rock Silt Check Type A
1630.01 Riser Basin	1634.01 Temporary Rock Sediment Dam Type A
1630.03 Temporary Silt Ditch	1634.02 Temporary Rock Sediment Dam Type B
1630.04 Stilling Basin	1635.01 Rock Pipe Inlet Sediment Trap Type A
1630.05 Temporary Diversion	1635.02 Rock Pipe Inlet Sediment Trap Type B

07-MAY-2012 13:46 C:\PROJECTS\PITT\FIRE TOWER_PORTERTOWN\Revised\FP_roundabout_psh.eci.dgn \$\$\$USER\$\$\$

8/17/99
 REVISIONS
 07-MAY-2012 13:46
 G:\PROJ\EC2\PORTERTOWN\FIRE_TOWER_PORTERTOWN\Revised\Fp-roundabout.psh_ec2.dgn
 \$\$\$\$SUSPENSE\$\$\$\$

NOTES: ANY DEVIATION FROM OPTIONS GIVEN WILL REQUIRE PRIOR APPROVAL BY ENGINEER.

 ADDITIONAL EROSION CONTROL DEVICES MAY NEED TO BE INSTALLED AS DIRECTED BY THE ENGINEER.

Std. #	Description	Symbol
1606.01	High Vis Temporary Silt Fence	
1633.03	Rock Inlet Sediment Trap Type C	
SP	Wattle with Polyacrylamide	
SP	Wattle	

PROJECT REFERENCE NO. **W-5202B** SHEET NO. **EC2**

 PLANS
 NAD 83/NSRS 2007

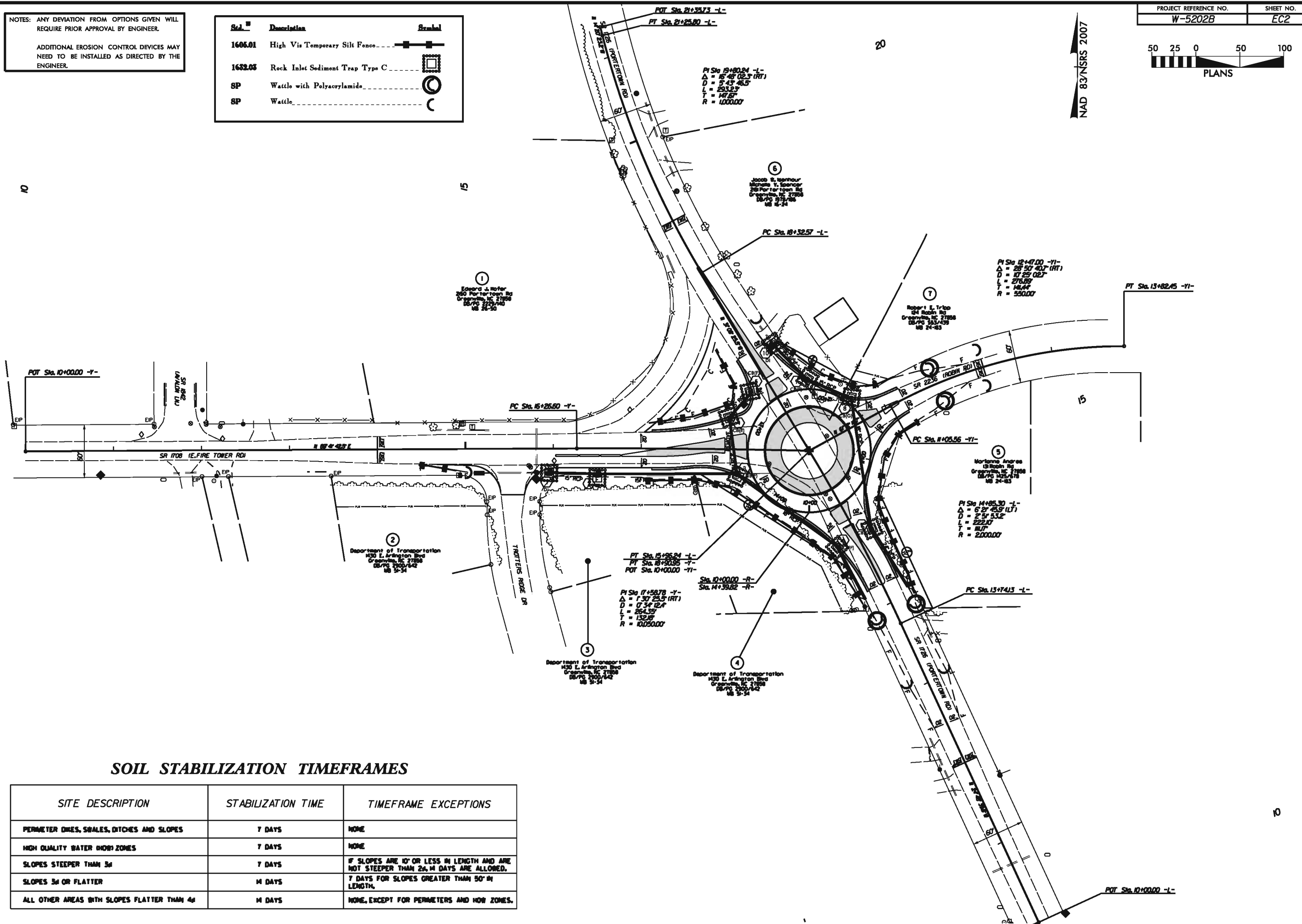

SOIL STABILIZATION TIMEFRAMES

SITE DESCRIPTION	STABILIZATION TIME	TIMEFRAME EXCEPTIONS
PERMETER DRES, SOALES, DITCHES AND SLOPES	7 DAYS	NONE
HIGH QUALITY WATER HOBZONES	7 DAYS	NONE
SLOPES STEEPER THAN 3d	7 DAYS	IF SLOPES ARE 10' OR LESS IN LENGTH AND ARE NOT STEEPER THAN 2%, 14 DAYS ARE ALLOWED.
SLOPES 3d OR FLATTER	14 DAYS	7 DAYS FOR SLOPES GREATER THAN 50' IN LENGTH.
ALL OTHER AREAS WITH SLOPES FLATTER THAN 4d	14 DAYS	NONE, EXCEPT FOR PERMETERS AND HOBZONES.

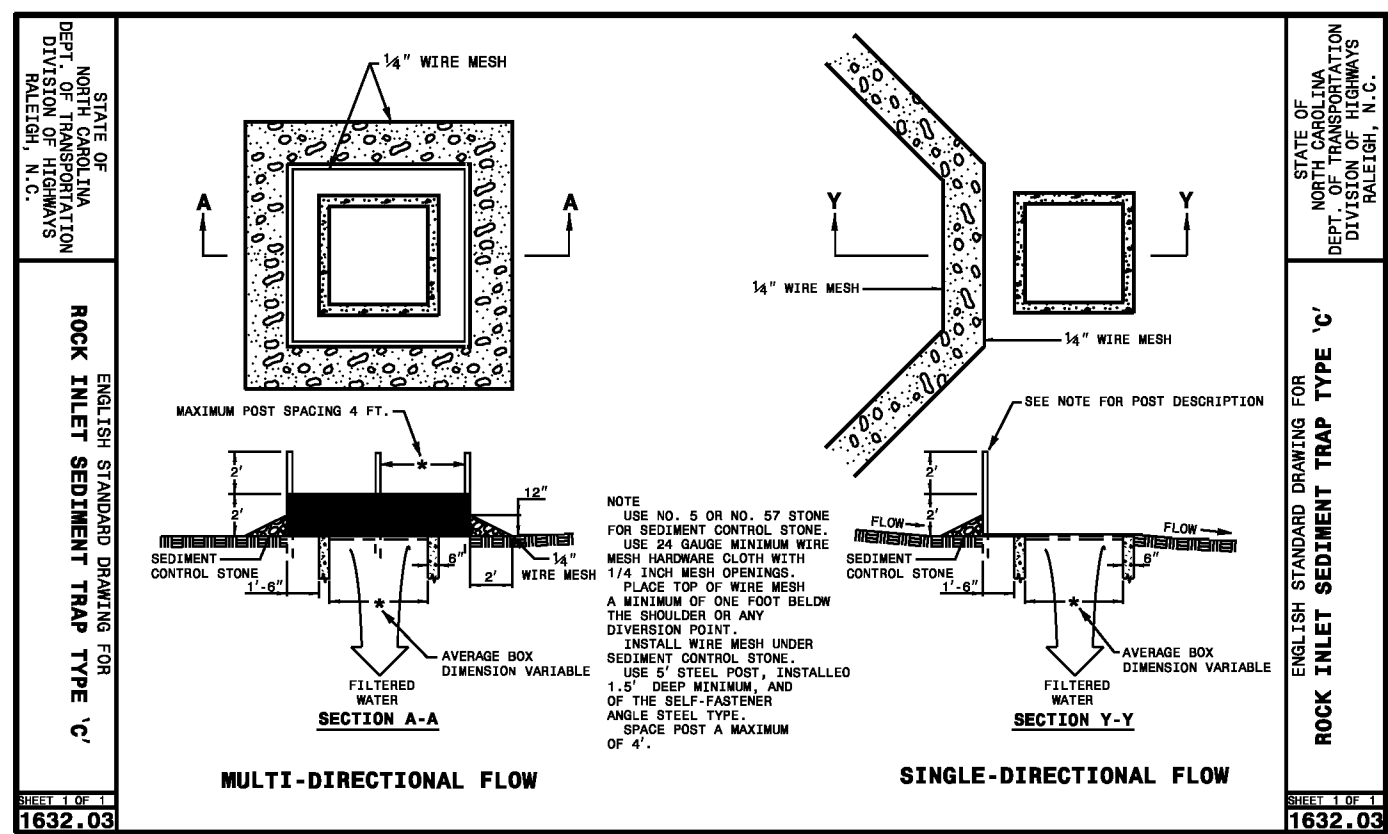
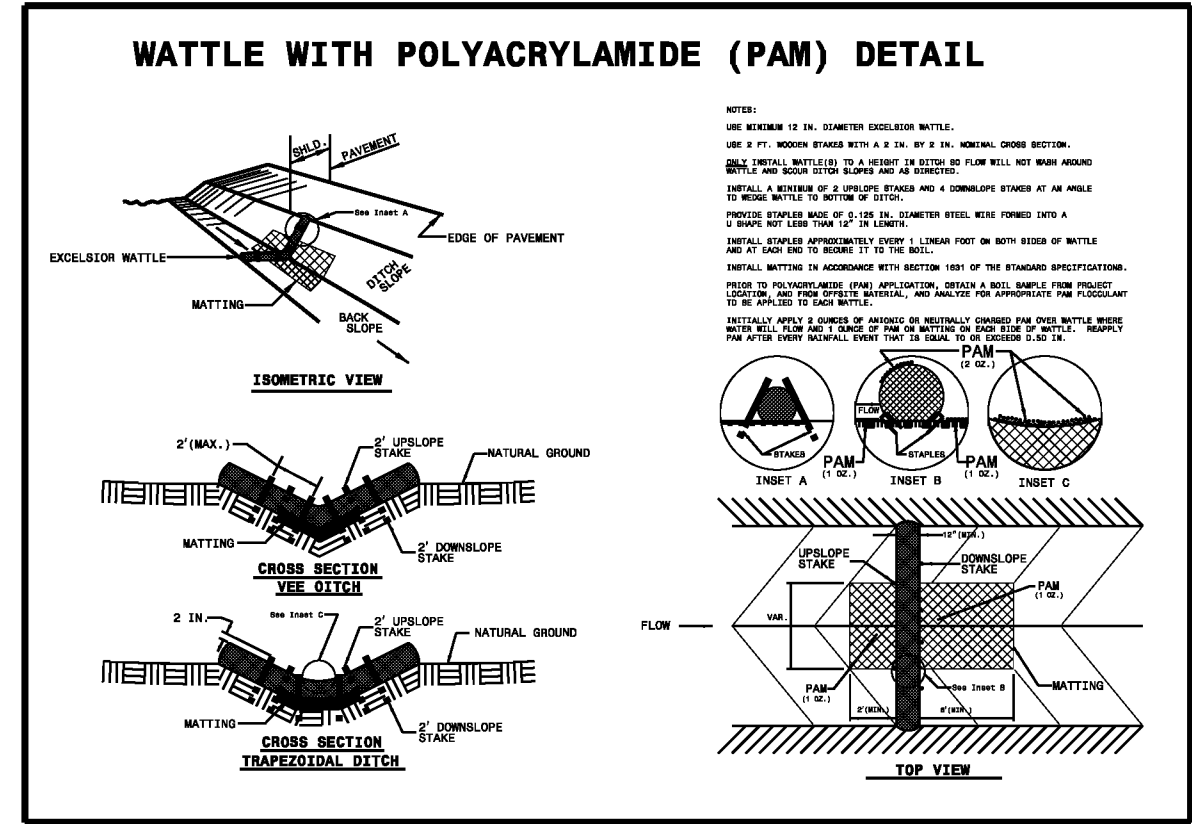
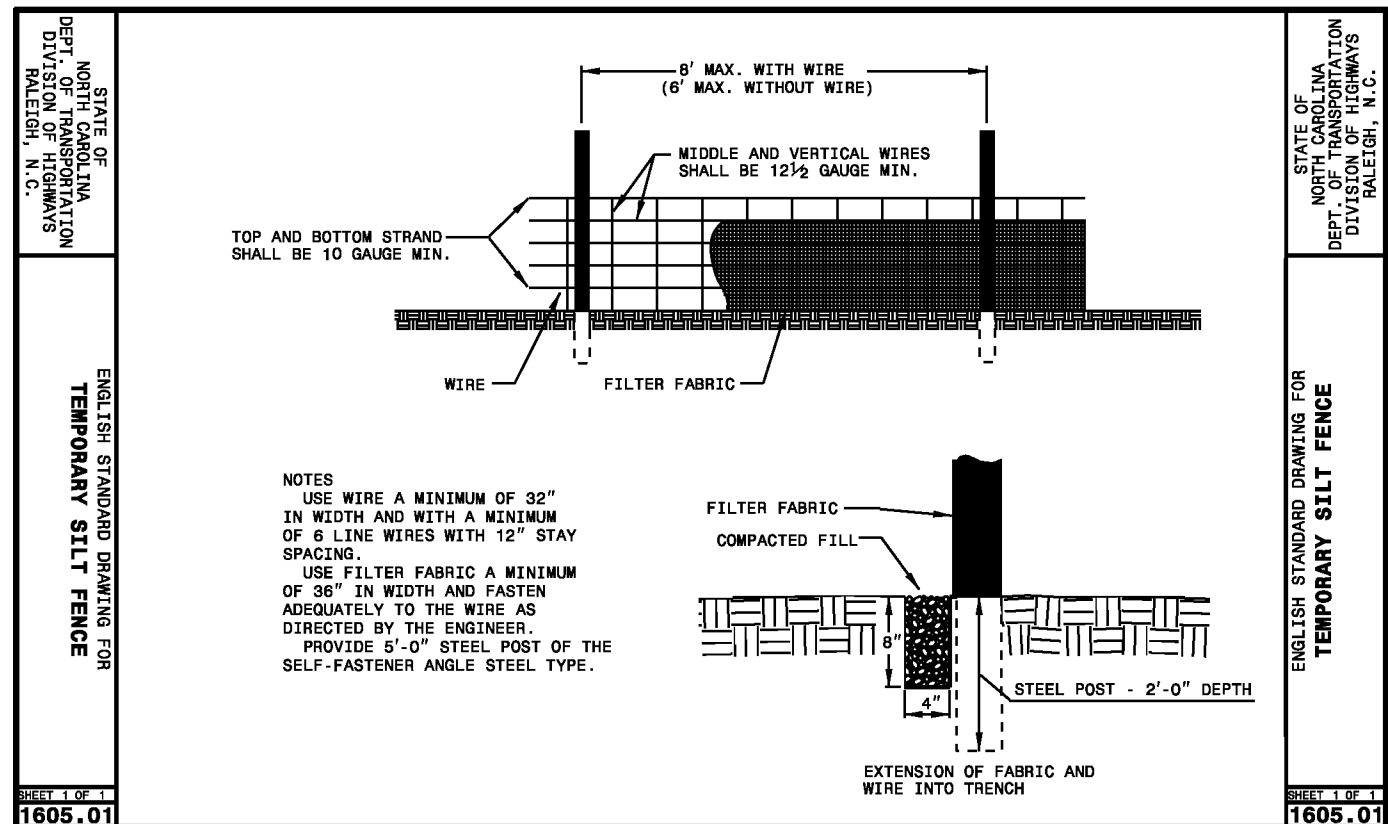

REVISIONS

8/17/99
 07-MAY-2012 13:46
 G:\PROJECTS\1111\FIRE TOWER-PORTERTOWN\Revised\Fp-roundabout.psh.ec3.dgn
 \$\$\$\$SUSPEND\$

8/17/99

07-MAY-2012 13:46 G:\PROJECTS\111\FIRE TOWER_PORTERTOWN\Revised\FP-roundabout.psh_uo1.dgn

REVISIONS

UTILITY OWNERS ON THIS PROJECT ARE AS FOLLOWS:

CENTURYLINK (PHONE/FIBER) - CONTACT: PAM ISLES PHONE: 252-355-4544
CENTURYLINK TO BE INCLUDED IN PRECONSTRUCTION MEETING.

EASTERN PINES WATER CORP. - CONTACT: BARRY SUTTON PHONE: 252-752-7420
WATER LINES SHALL BE RELOCATED PRIOR TO CONSTRUCTION.

GUC (POWER) - CONTACT: JEFF OAKLEY PHONE: 252-551-1584 EMAIL: DAKLEYCJ@GUC.COM
PDWER POLES SHALL BE RELOCATED PRIOR TO CONSTRUCTION.

GUC (GAS) - CONTACT: CHARLES BUCK PHONE: 252-551-1593 EMAIL: BUCKCR@GUC.COM
CONTACT: JASON CYPHERS PHONE: SAME EMAIL: CYPHERJA@GUC.COM
GAS WILL BE RELOCATED DURING CONSTRUCTION.
GUC (GAS) TO BE INCLUDED IN PRECONSTRUCTION MEETING.

SUDDENLINK (CATV) - CONTACT:

LEGEND:

○ RELOCATE POWER POLE / ADJUST GAS LINE / RELOCATE PHONE/CATV PEDESTAL

PROJECT REFERENCE NO.	SHEET NO.
W-5202B	U01

50 25 0 50 100
PLANS

NAD 83/NSRS 2007

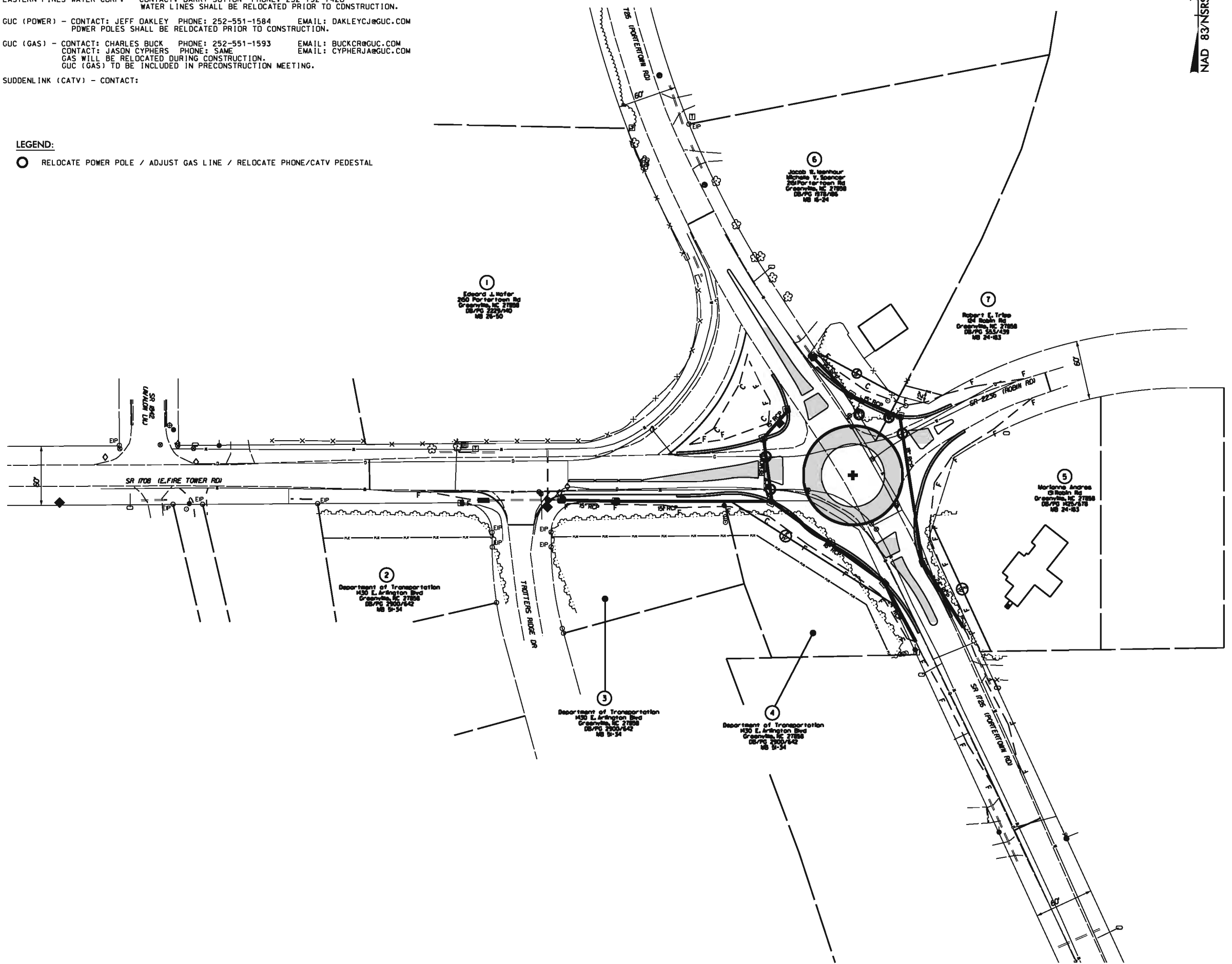

EASTERN PINES WATER CORPORATION

NCDOT FIRETOWER RD & PORTERTOWN RD INTERSECTION WATER MAIN RELOCATION

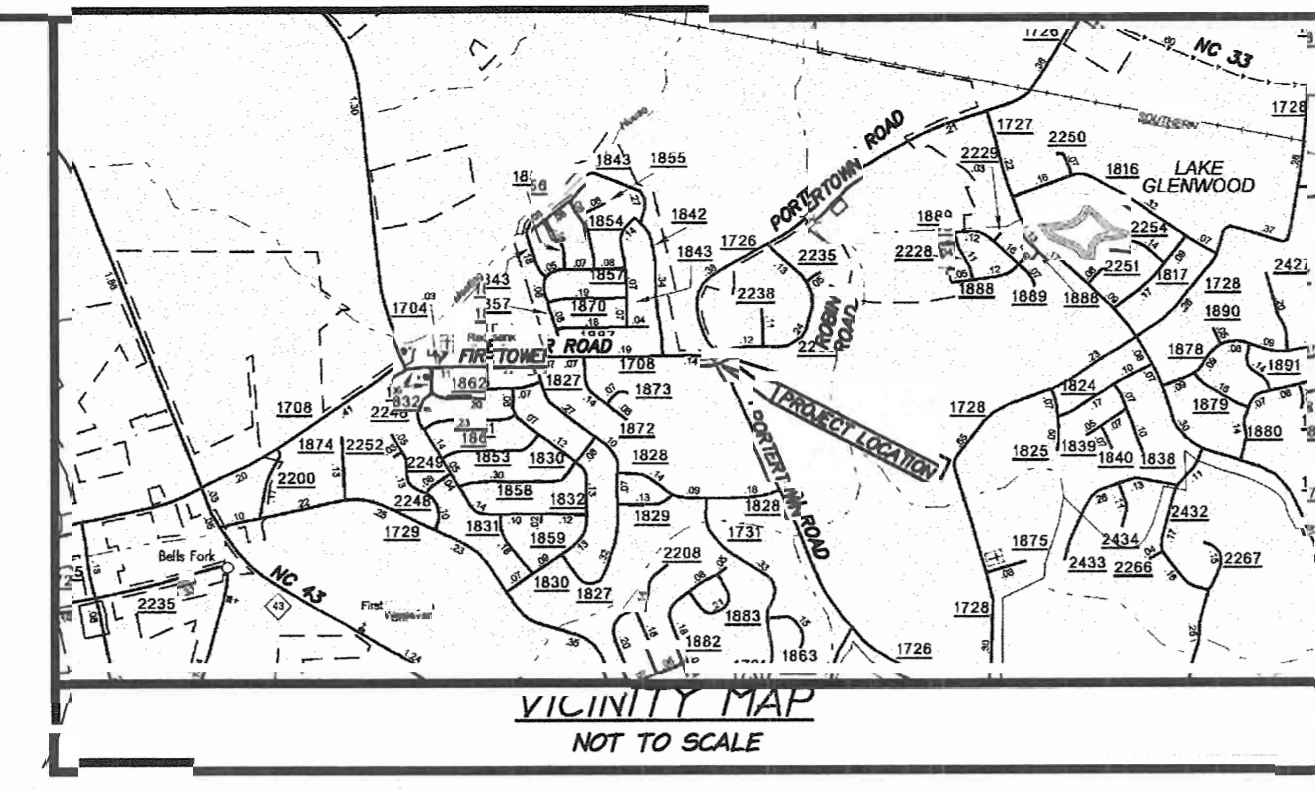

NO.	DATE	DESCRIPTION

SHEET INDEX	
1	COVER SHEET AND WATER MAIN LAYOUT
2	MISCELLANEOUS DETAILS
3	MISCELLANEOUS DETAILS

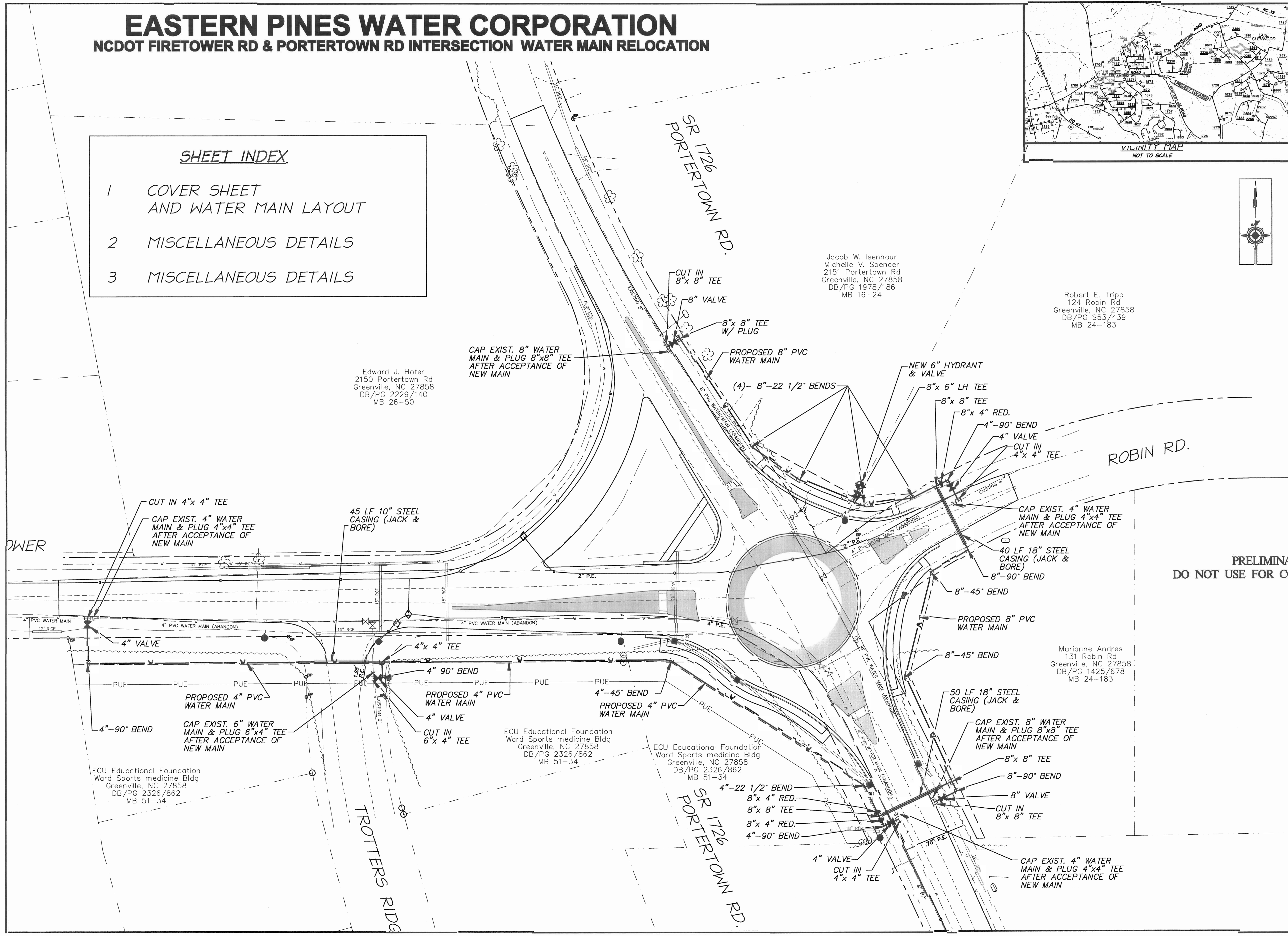

Jacob W. Isehour
Michelle V. Spencer
2151 Portertown Rd
Greenville, NC 27858
DB/PG 1978/186
MB 16-24

Robert E. Tripp
124 Robin Rd
Greenville, NC 27858
DB/PG S53/439
MB 24-183

Edward J. Hofer
2150 Portertown Rd
Greenville, NC 27858
DB/PG 2229/140
MB 26-30

CAP EXIST. 8" WATER MAIN & PLUG 8"x8" TEE AFTER ACCEPTANCE OF NEW MAIN

CUT IN 4"x4" TEE
CAP EXIST. 4" WATER MAIN & PLUG 4"x4" TEE AFTER ACCEPTANCE OF NEW MAIN

45 LF 10" STEEL CASING (JACK & BORE)

CAP EXIST. 4" WATER MAIN & PLUG 4"x4" TEE AFTER ACCEPTANCE OF NEW MAIN
40 LF 18" STEEL CASING (JACK & BORE)

PROPOSED 4" PVC WATER MAIN
CAP EXIST. 6" WATER MAIN & PLUG 6"x4" TEE AFTER ACCEPTANCE OF NEW MAIN

PROPOSED 4" PVC WATER MAIN
4" VALVE
CUT IN 6"x4" TEE

ECU Educational Foundation
Ward Sports medicine Bldg
Greenville, NC 27858
DB/PG 2326/862
MB 51-34

ECU Educational Foundation
Ward Sports medicine Bldg
Greenville, NC 27858
DB/PG 2326/862
MB 51-34

Marianne Andres
131 Robin Rd
Greenville, NC 27858
DB/PG 1425/678
MB 24-183

50 LF 18" STEEL CASING (JACK & BORE)
CAP EXIST. 8" WATER MAIN & PLUG 8"x8" TEE AFTER ACCEPTANCE OF NEW MAIN

ECU Educational Foundation
Ward Sports medicine Bldg
Greenville, NC 27858
DB/PG 2326/862
MB 51-34

4"-22 1/2" BEND
8"x4" RED.
8"x8" TEE
8"x4" RED.
4"-90" BEND

CAP EXIST. 4" WATER MAIN & PLUG 4"x4" TEE AFTER ACCEPTANCE OF NEW MAIN

WATER MAIN LAYOUT
EASTERN PINES WATER CORPORATION
FIRETOWER AND PORTERTOWN ROAD
WATER MAIN RELOCATION
 PITT COUNTY, NORTH CAROLINA

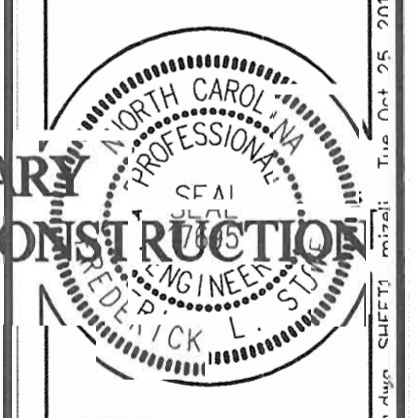

Rivers & Associates, Inc.
Professional Engineer
197 East Second Street
Greenville, NC 27608 (919) 708-5077
NC License #4008

Project Manager:	FLS
Project Engineer:	FLS
Designed By:	FLS
Drawn By:	JIM/JML
Checked By:	FLS
Project Number:	2011046
Drawing Number:	W-3401
Scale:	HORZ. 1"=30'

DIVISION OF HIGHWAYS
STATE OF NORTH CAROLINA

CROSS-SECTION SUMMARY

IN CUBIC YARDS

NOTE: Approximate quantities only. Unclassified excavation, Borrow Excavation, Fine Grading, Clearing and Grubbing, Removal of Existing Pavement and Breaking of Existing Pavement will be paid for at the contract Lump Sum price for "Grading".

NOTE: EMBANKMENT COLUMN DOES NOT INCLUDE BACKFILL FOR UNDERCUT.

LOCATION (-R-)	UNCLASSIFIED EXCAVATION	UNDERCUT	EMBANKMENT
10 + 00.00	0	0	0
10 + 50.00	2	0	177
10 + 65.83	0	0	56
11 + 00.00	2	0	137
11 + 16.55	1	0	60
11 + 50.00	0	0	121
11 + 71.87	0	0	87
12 + 00.00	8	0	114
12 + 22.30	18	0	79
12 + 50.00	21	0	94
12 + 88.59	18	0	138
13 + 00.00	3	0	40
13 + 50.00	4	0	152
13 + 59.68	3	0	32
14 + 00.00	36	0	137

LOCATION (-L-)	UNCLASSIFIED EXCAVATION	UNDERCUT	EMBANKMENT
13 + 00.00	0		0
13 + 50.00	0		9
14 + 00.00	0		18
14 + 50.00	1		42
15 + 00.00	2		91
15 + 26.23	2		80
ROUNDABOUT			
17 + 00.00	0		0
17 + 50.00	37		29

LOCATION (-Y-)	UNCLASSIFIED EXCAVATION	UNDERCUT	EMBANKMENT
15 + 00.00	0	0	0
16 + 00.00	6	0	22
16 + 50.00	3	0	22
17 + 00.00	1	0	31
17 + 50.00	30	0	46
18 + 00.00	80	0	44
ROUNDABOUT			

LOCATION (-Y1-)	UNCLASSIFIED EXCAVATION	UNDERCUT	EMBANKMENT
ROUNDABOUT			
10 + 70.00	0	0	0
11 + 00.00	6	0	33
11 + 50.00	9	0	35

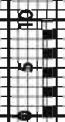
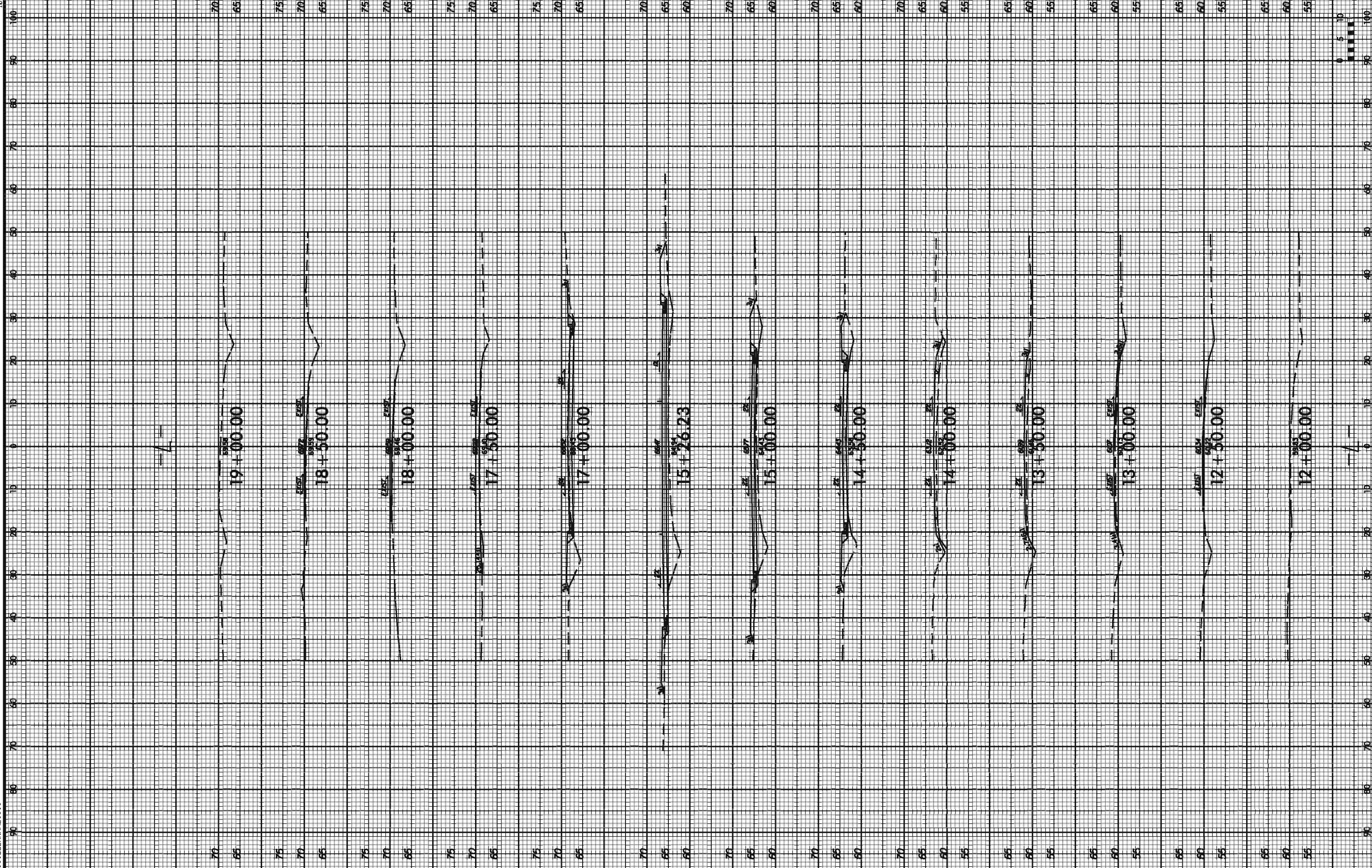

19+00.00

18+50.00

18+00.00

17+50.00

17+00.00

15+26.23

15+00.00

14+50.00

14+00.00

13+50.00

13+00.00

12+50.00

12+00.00

70

65

75

70

65

75

70

65

75

70

65

75

70

65

70

65

60

70

65

60

70

65

60

70

65

60

55

65

60

55

65

60

55

65

60

55

65

60

55

65

60

70

65

75

70

65

75

70

65

75

70

65

75

70

65

70

65

60

70

65

60

70

65

60

70

65

60

55

65

60

55

65

60

55

65

60

55

65

60

55

65

60

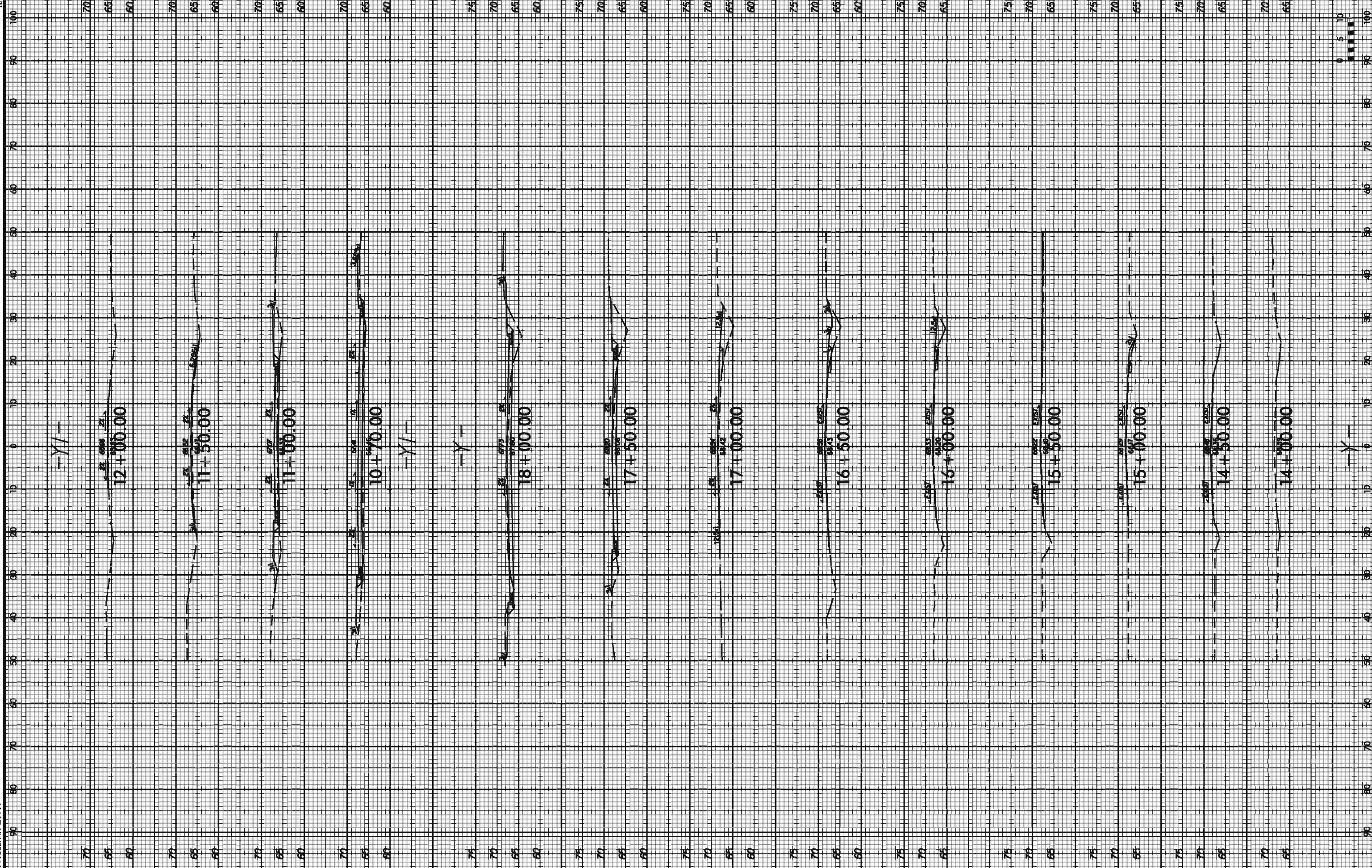

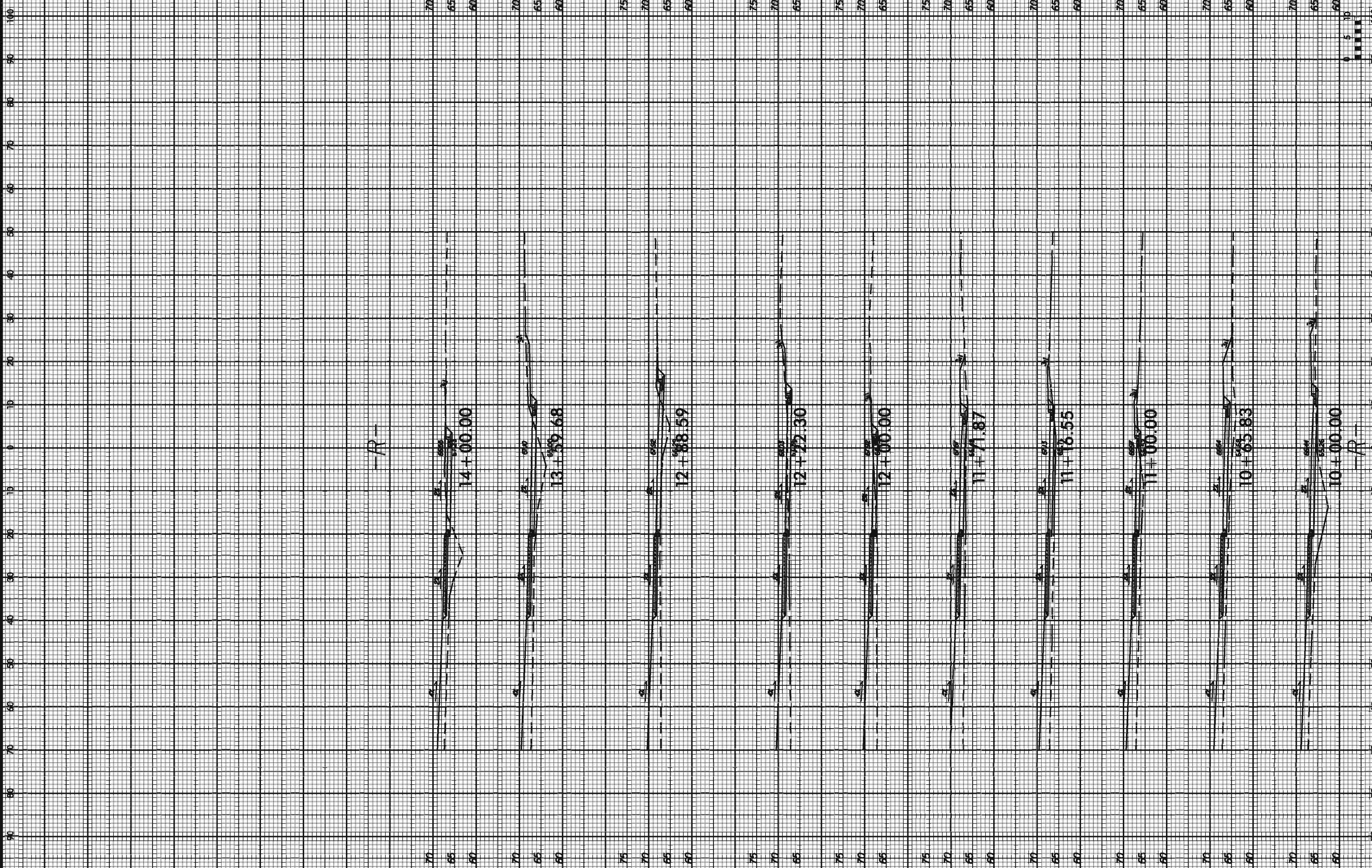

--R--

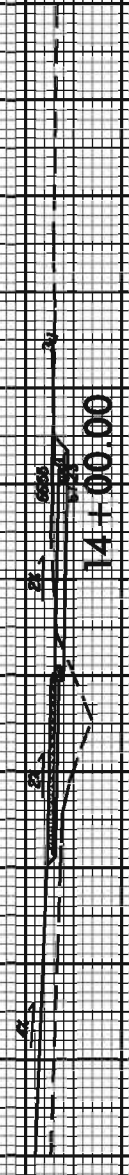

14+00.00

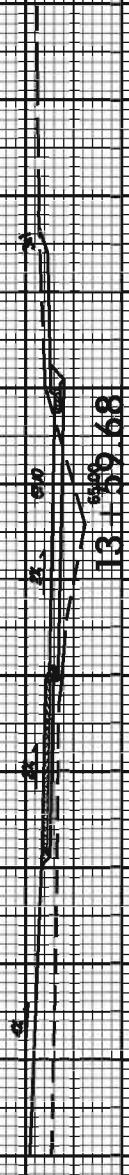

13+59.68

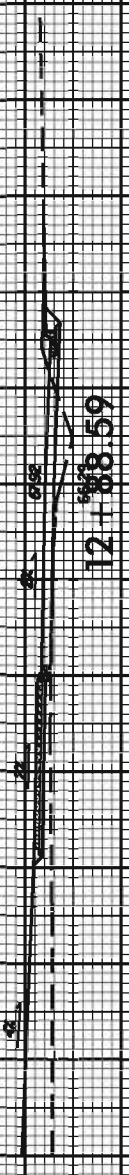

12+88.59



12+22.30



12+00.00



11+71.87



11+16.55

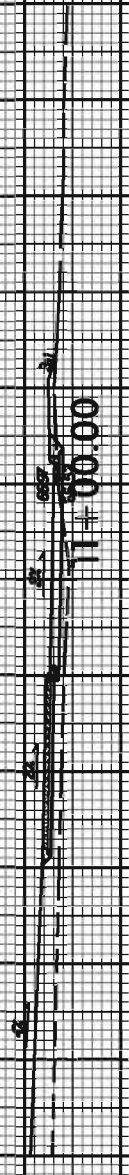

11+00.00

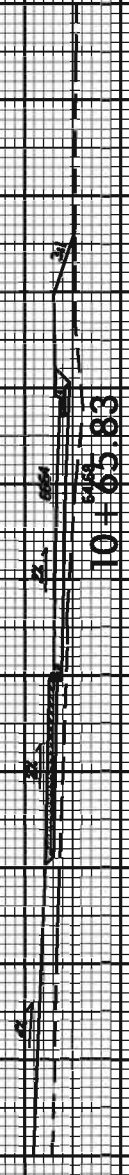

10+65.83

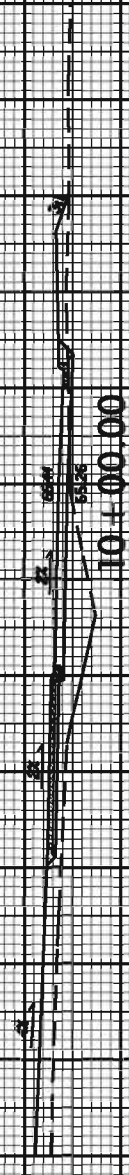

10+00.00

--R--

